

FIAT Strada Fuel Circuit Purge

Supported equipment: Launch's full range of comprehensive diagnostic equipment

Current equipment: PAD V

Functional description: During the initial startup phase of a FIAT or after a fuel system component is replaced, it is necessary to perform this program to eliminate the air in the fuel circuit.

Tested model: 2022/Fiat/Strada, VIN: 9BD281B41NYW *****

1. On a PAD 5, choose [Local Diagnose] and then [FIAT] to test.

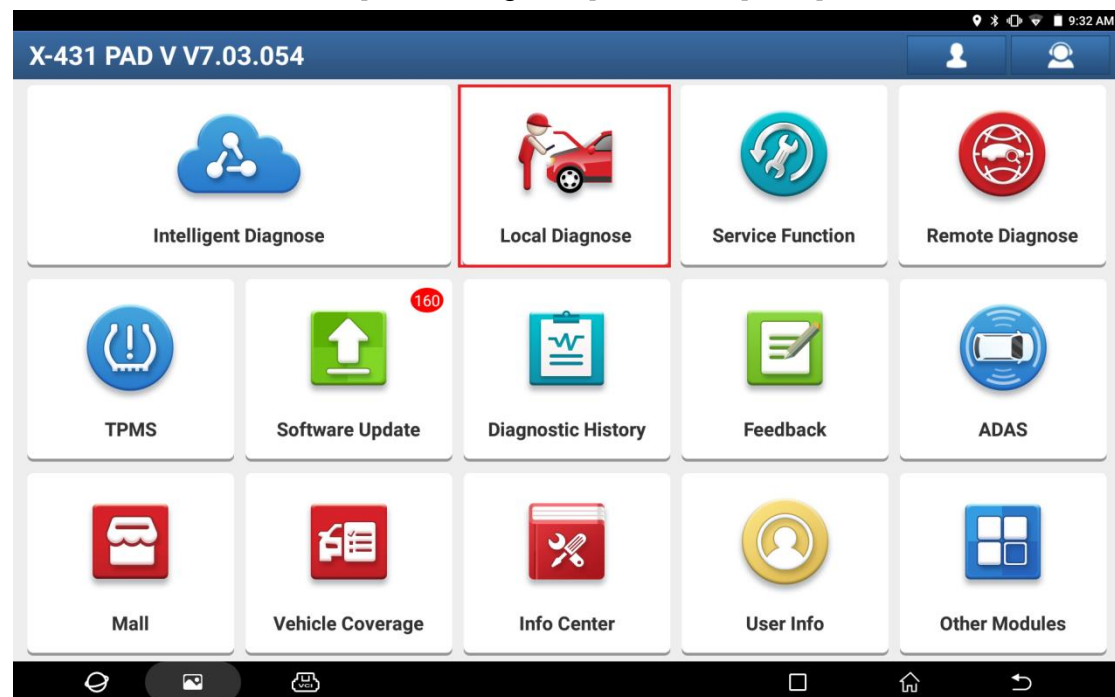

Local Diagnose

Enter the model name

VIN scanAllCommonAmericanEuropeanAsianChineseCan Bus Pin DetectionPurchase

Diagnostics for

ABARTH

by LAUNCH

Diagnostics for

ALFA ROMEO

by LAUNCH

Diagnostics for

CHRYSLER

by LAUNCH

Diagnostics for

DODGE

by LAUNCH

Diagnostics for

FIAT

by LAUNCH

Diagnostics for

JEEP

by LAUNCH

Diagnostics for

LANCIA

by LAUNCH

Vehicle Version Information

Software ID

Version #

FIAT

V38.50

FIAT V38.50

Introduction

ECU Coverage:

This Software Diagnoses All FIAT Series ECUs, Including Engine, AT, ABS, SRS, A/C, Instrument, Power Steering, Body PC, Door Control, Tire Pressure Control, Parking Control And Headlamp, Etc.

(The Following Models Covered Are Only For Reference And Will Vary Constantly With The Upgrades Of Software.)

Basic Functions Include:

- Reading ECU Information
- Reading DTCs
- Clearing DTCs
- Reading Vehicle Running Data
- Vehicle component Operation Test

Special functions include:

- Key Programming([Body Module])
- Tire Pressure detection([Body Module]/[Tire Pressure Control])
- Reset Adaptation

Vehicle Coverage

OK

- Choose [Automatically Search] to identify car models automatically. After the car model is successfully identified, choose OK.

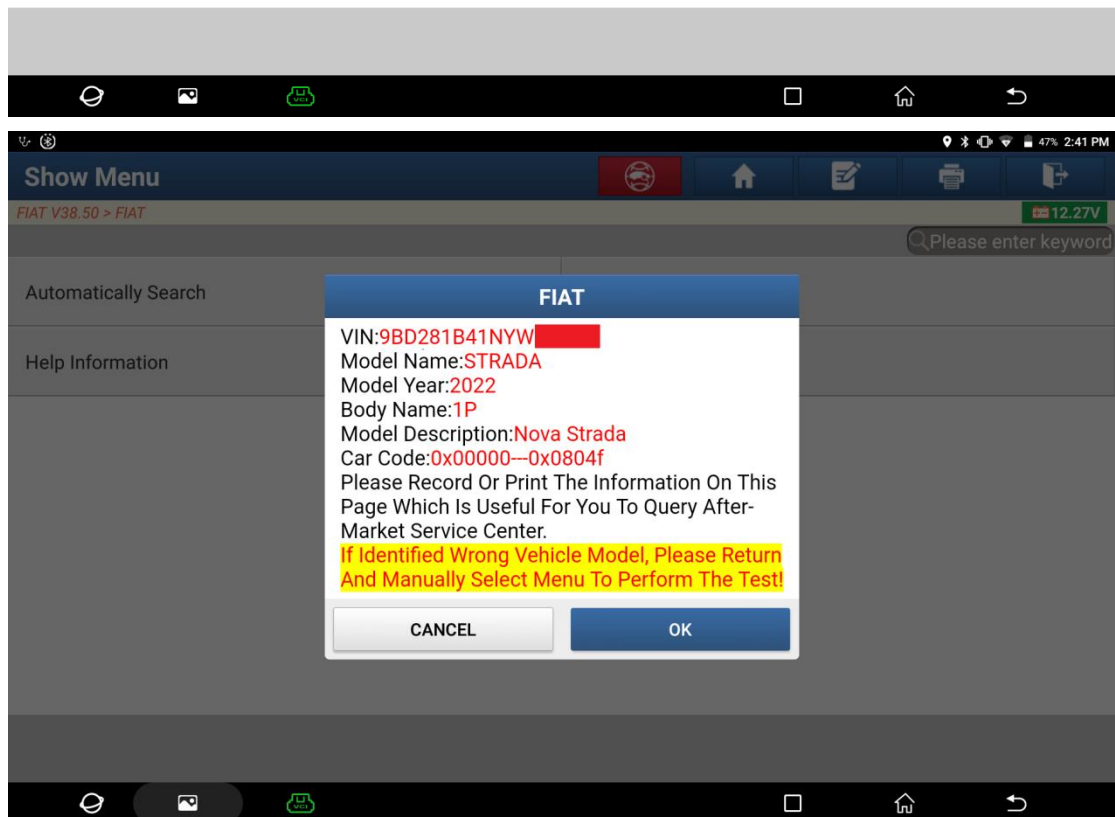
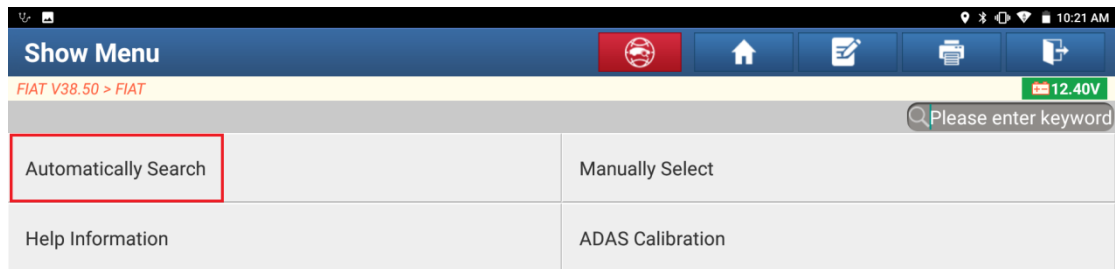

3. Choose “Yes” to unlock the SGW.

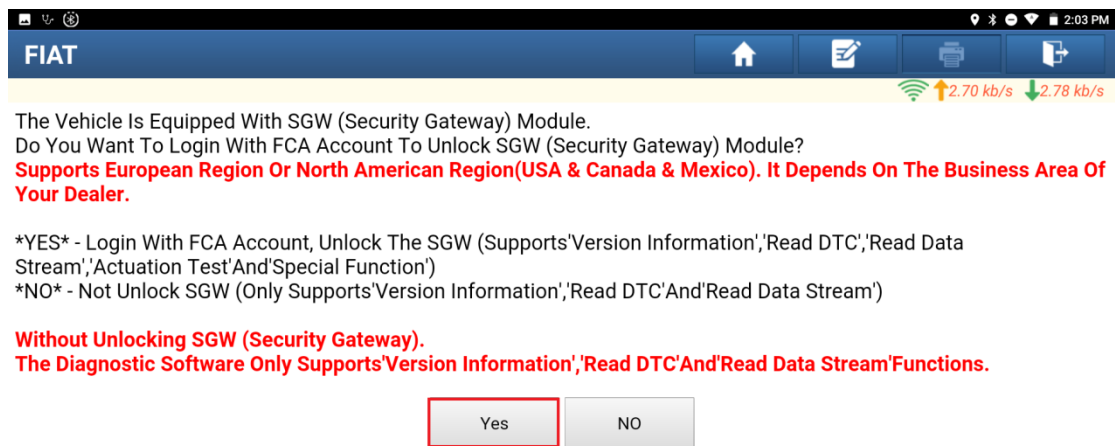

4. Choose [North America] for the region.

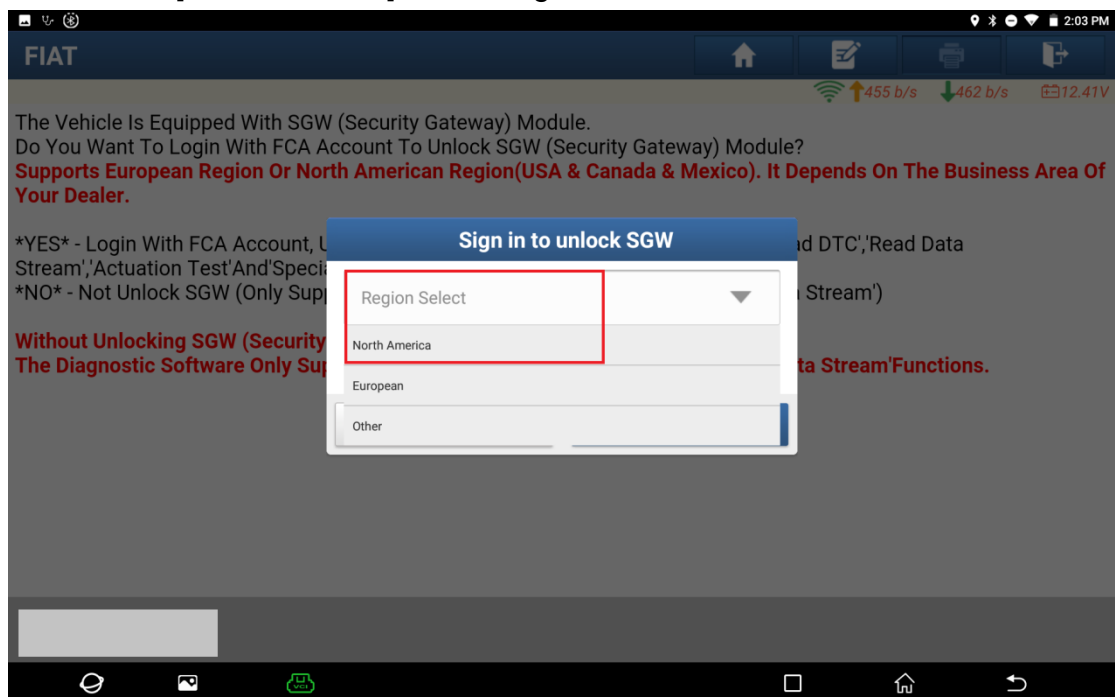

5. Input the login user name and password, and click OK.

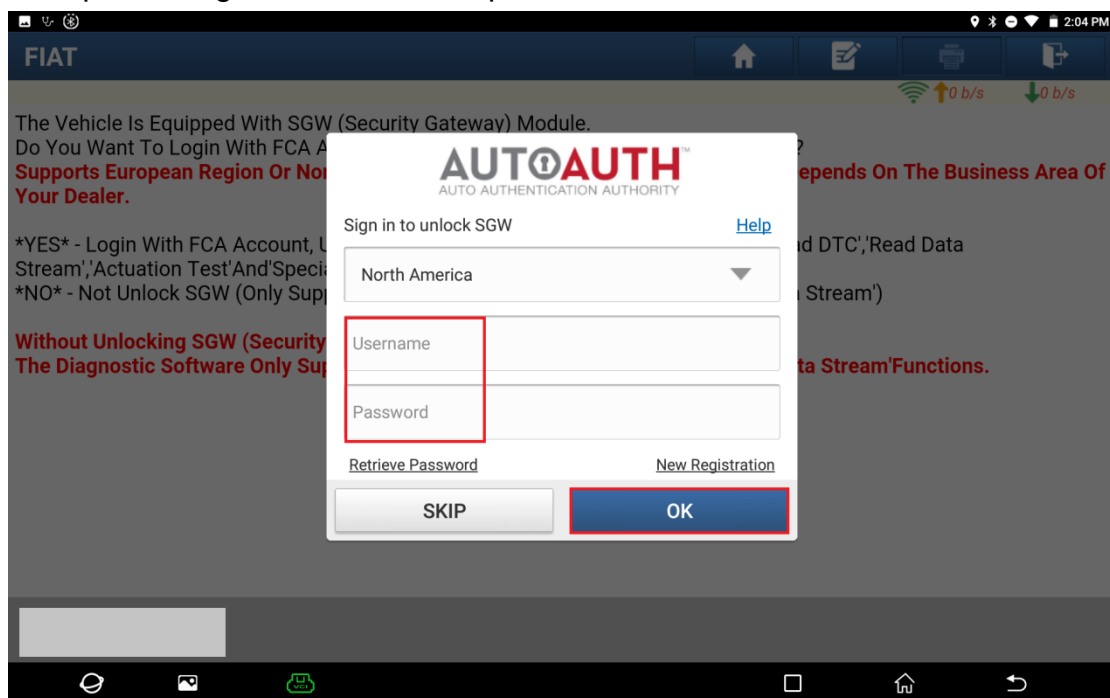

6. Unlocking is successful. Click OK.

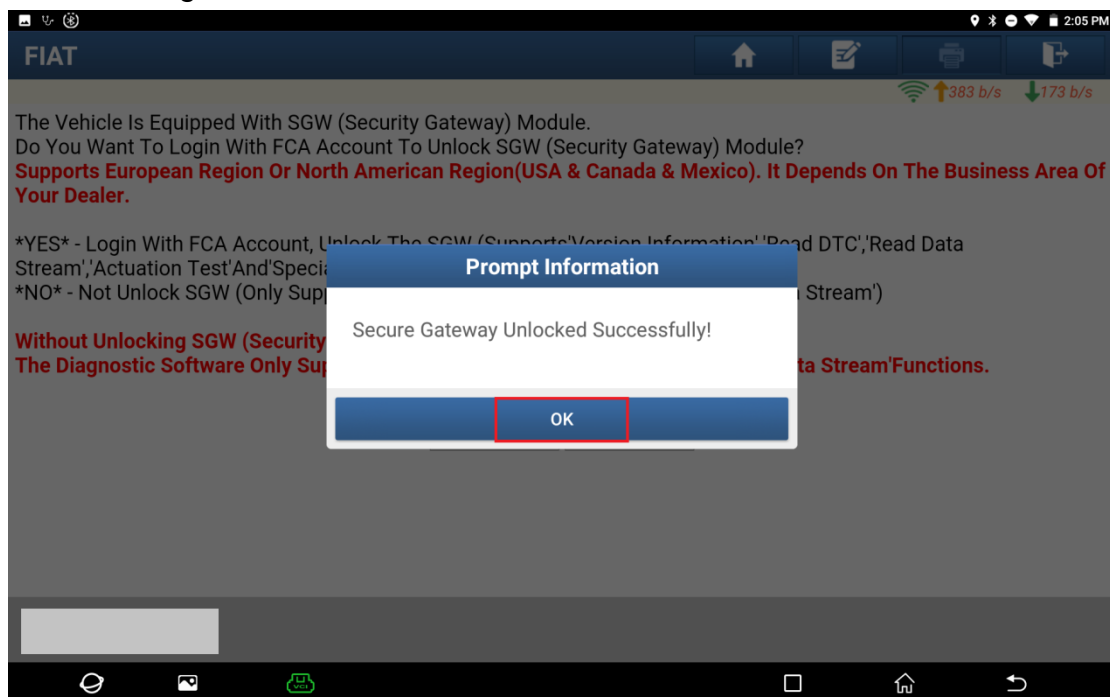

7. Click [Smart Detection] to scan the entire vehicle systems.

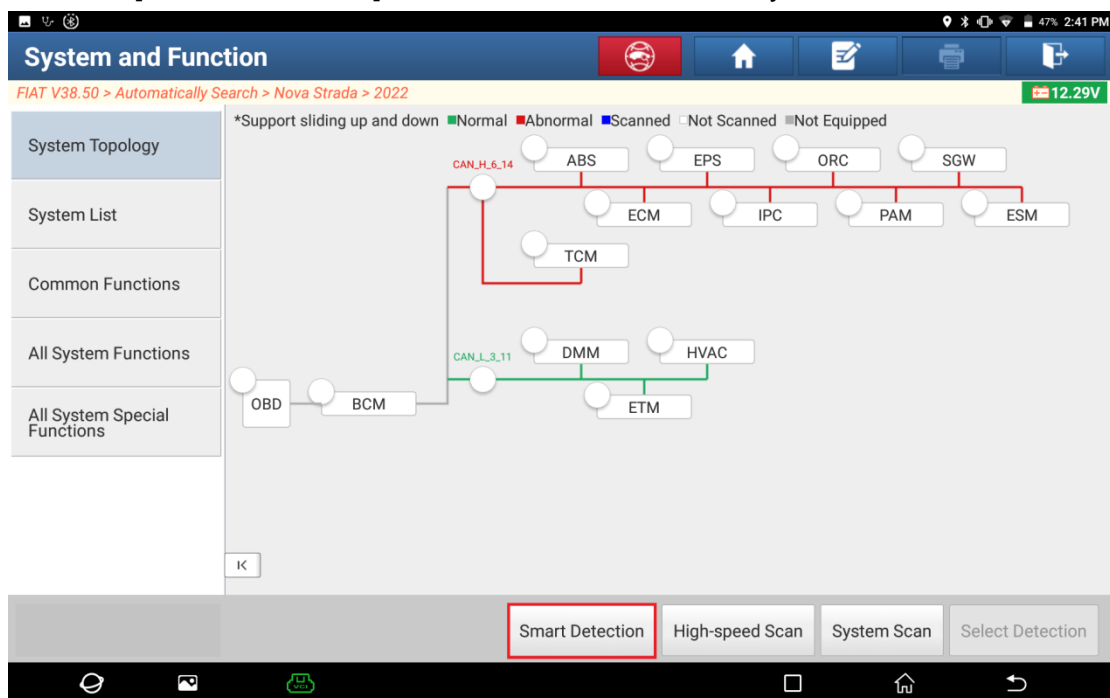

8. Click [ECM (Engine Control Module)] to access the system.

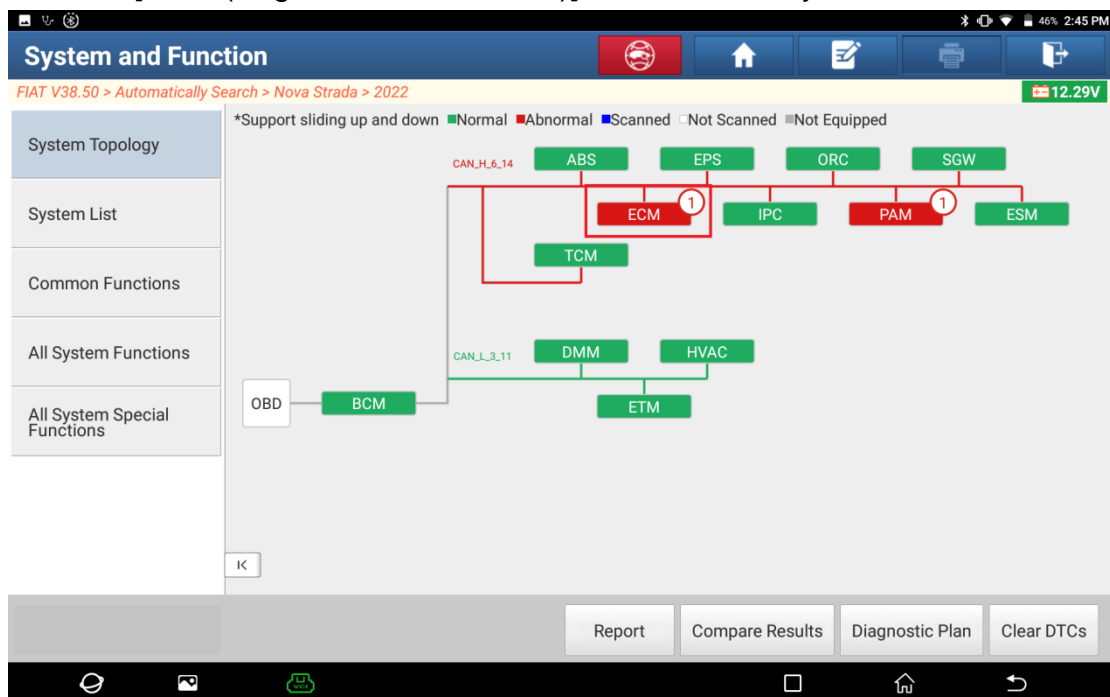

9. Click [Special Function] and click OK.

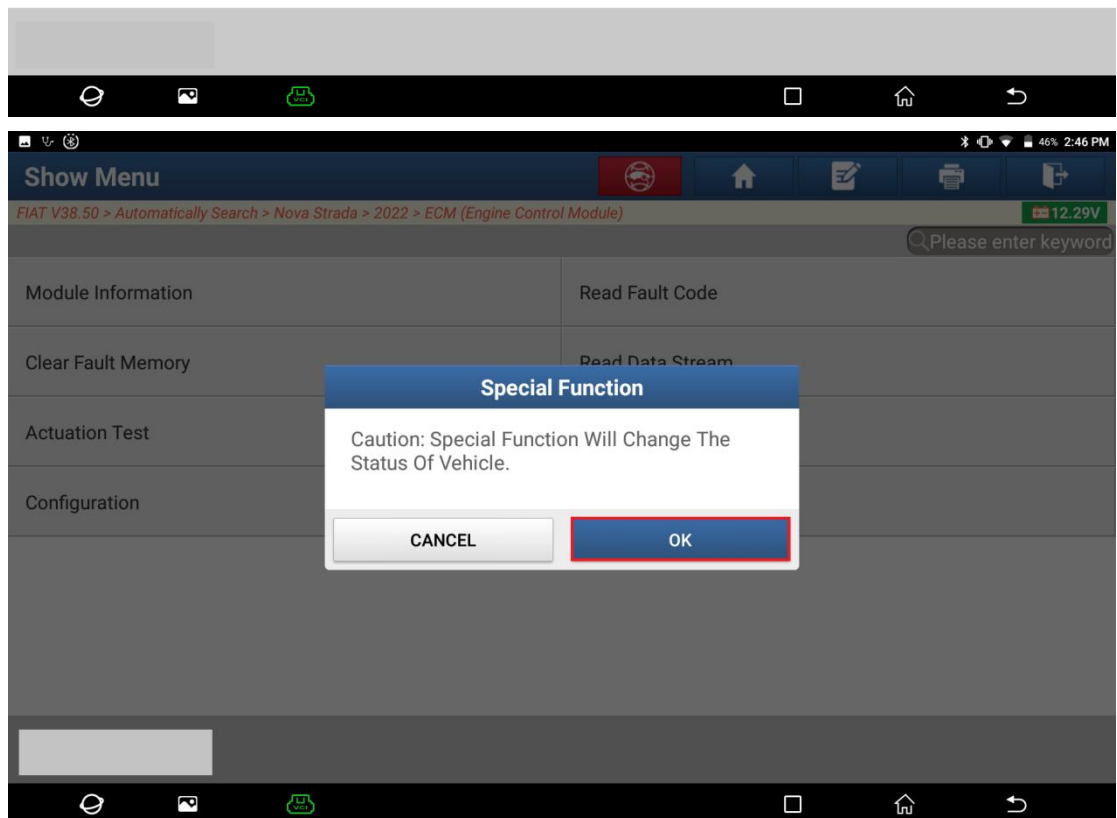
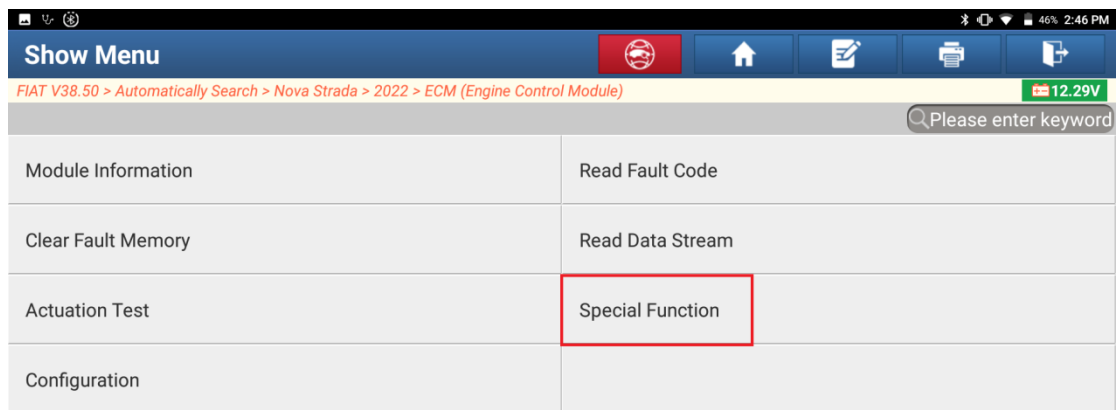

10. Choose [Misc Function].

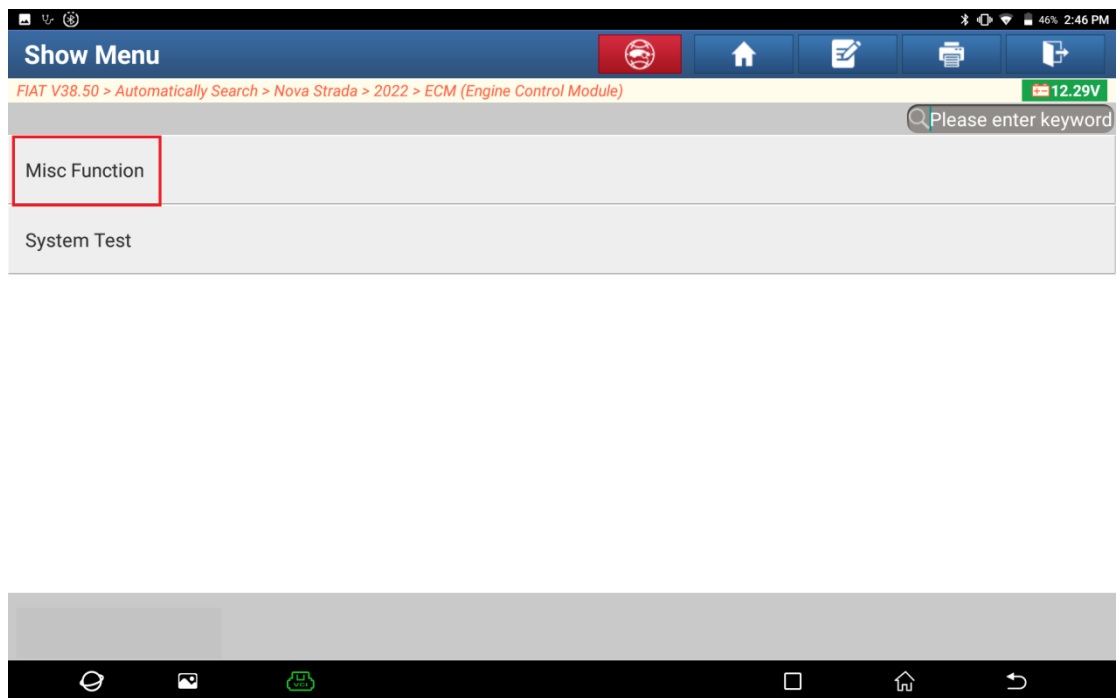

11. Choose [Fuel Circuit Purge].

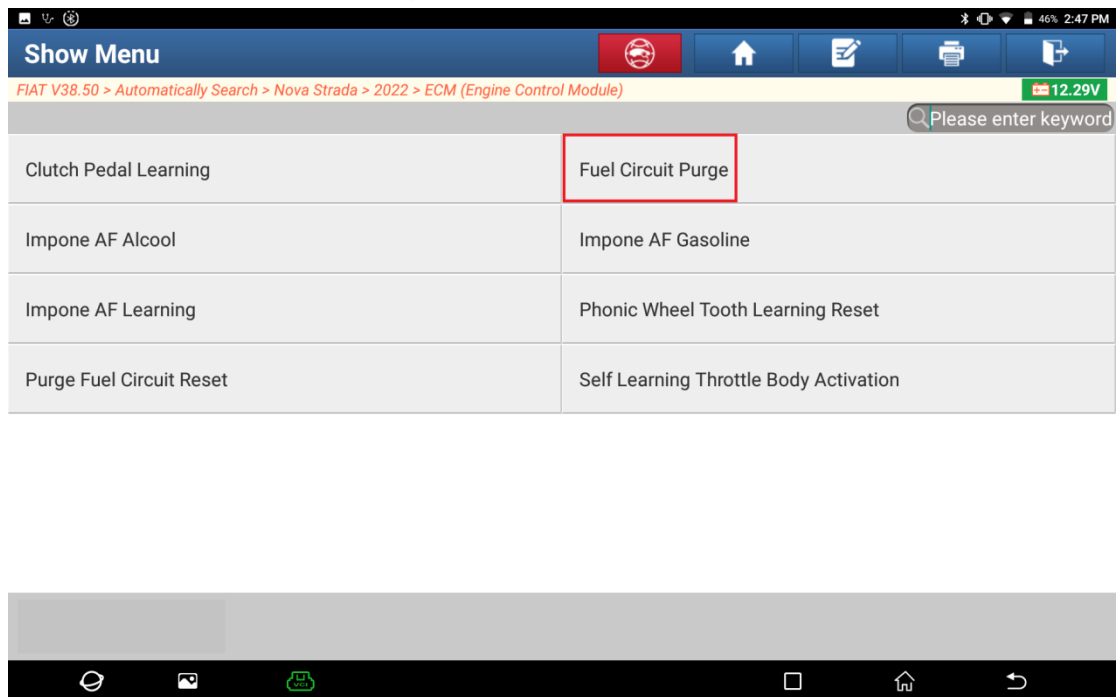

12. Click OK.

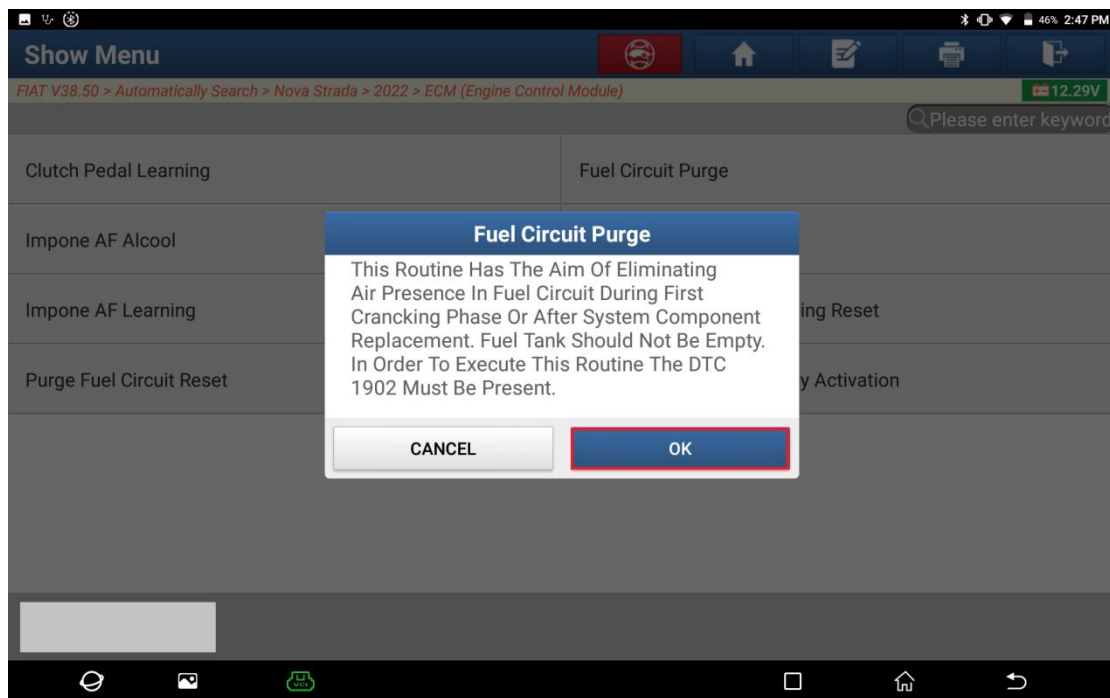

13. Wait for the countdown to end.

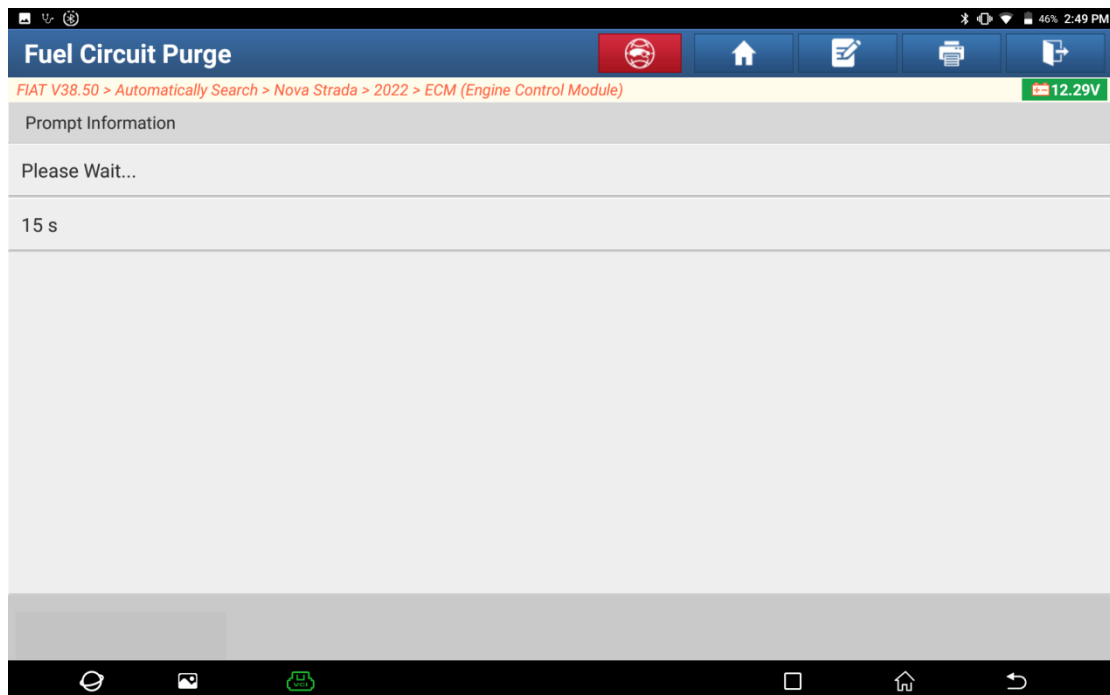

14. Click OK.

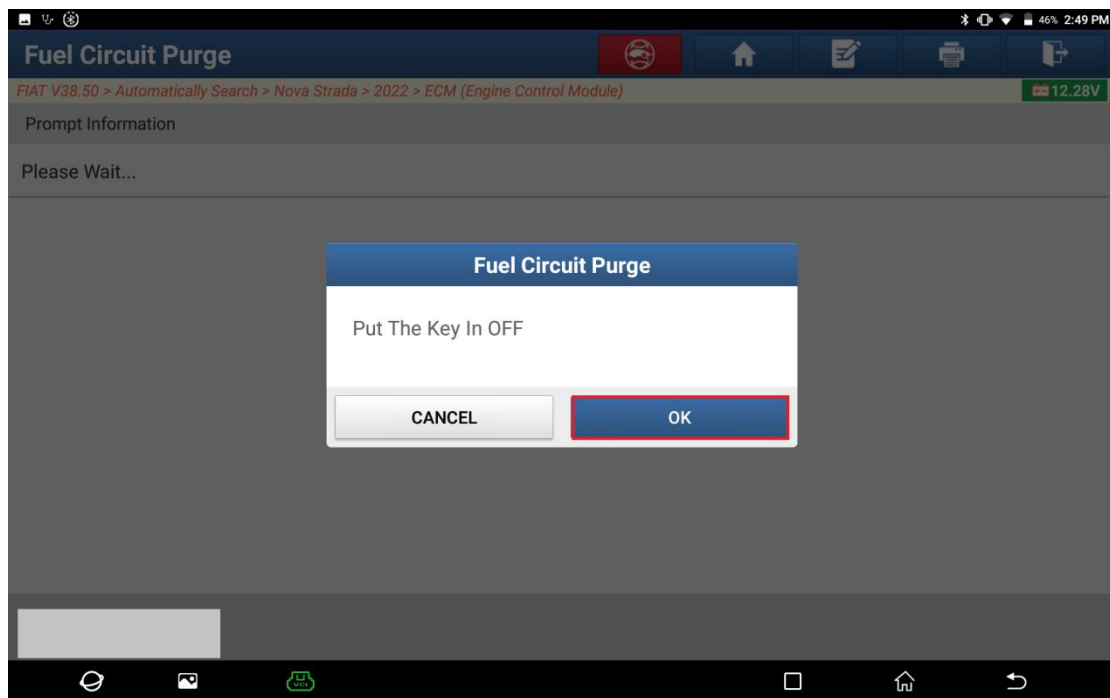

15. Wait for the countdown to end.

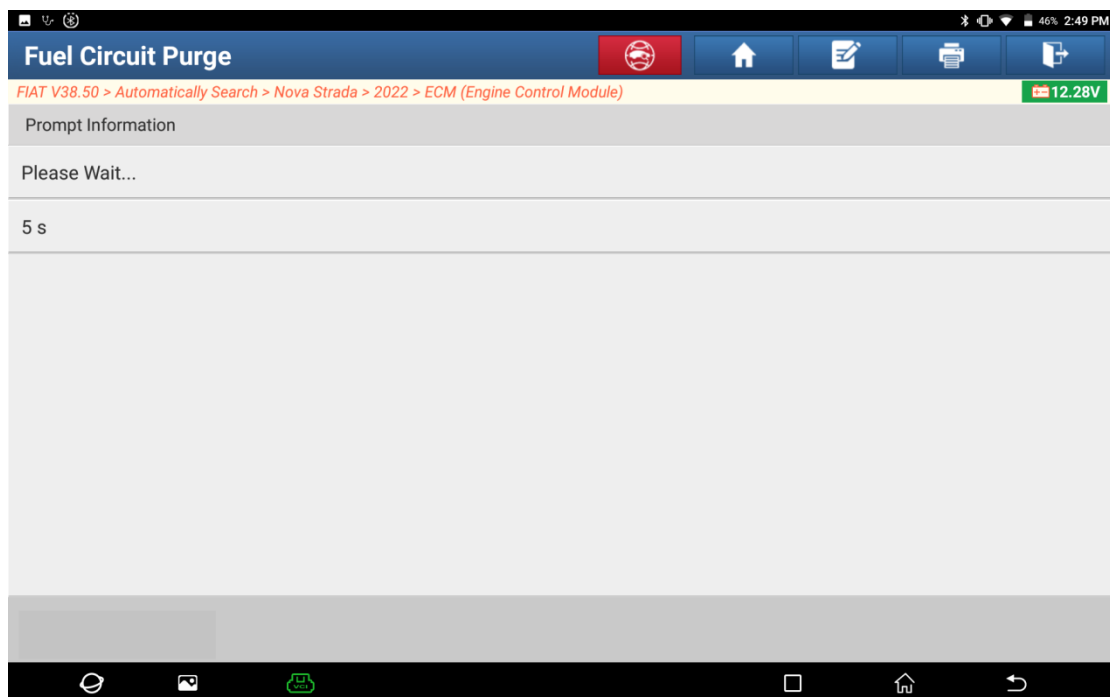

16. Click OK.

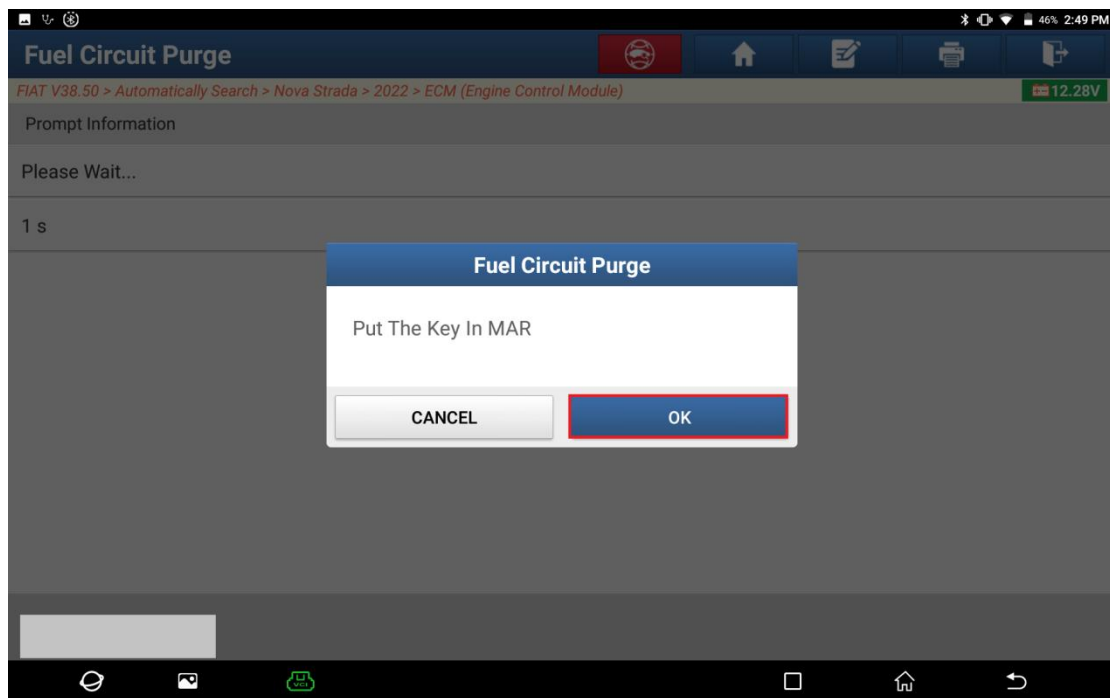

17. Click OK.

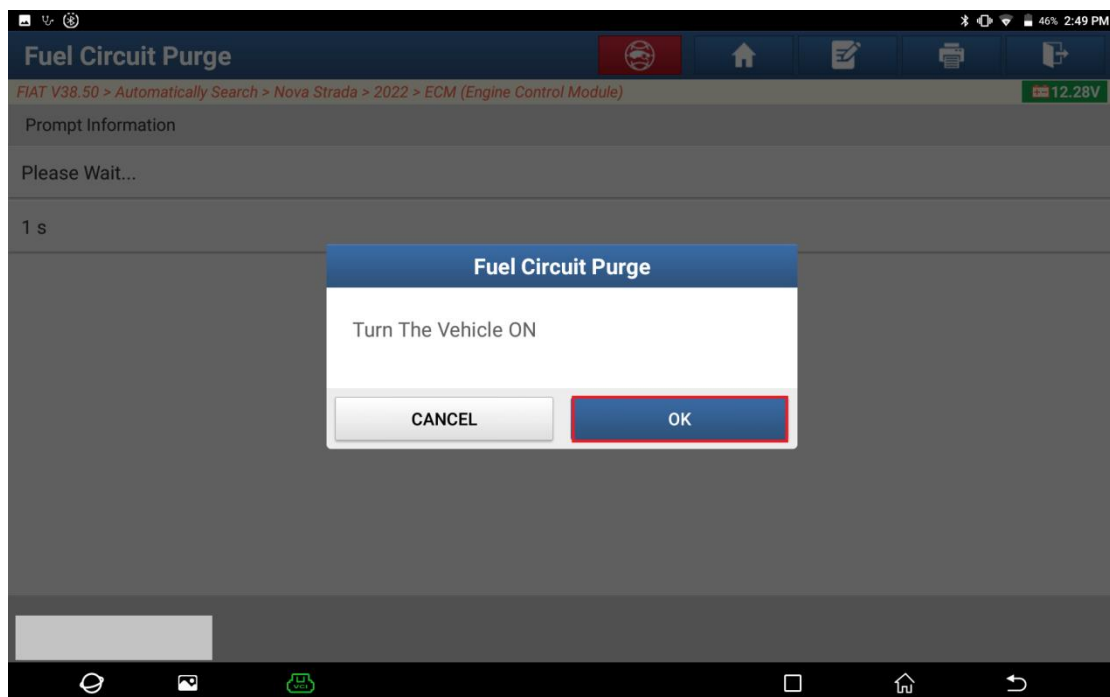

18. Click YES.

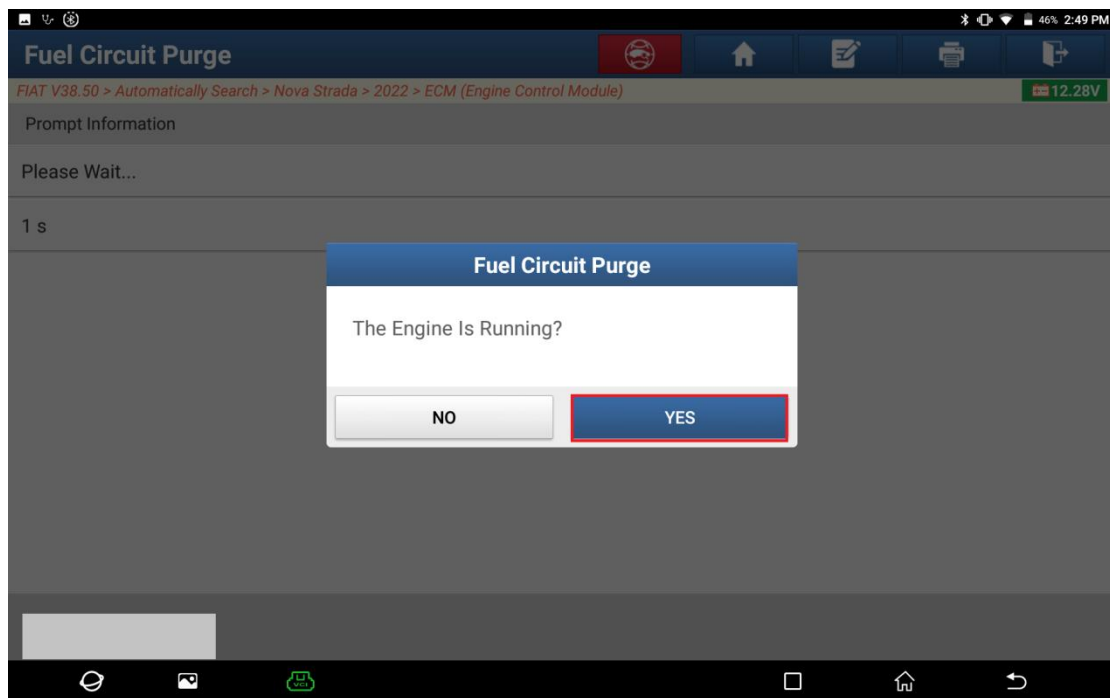

19. Click OK. Program execution is completed.

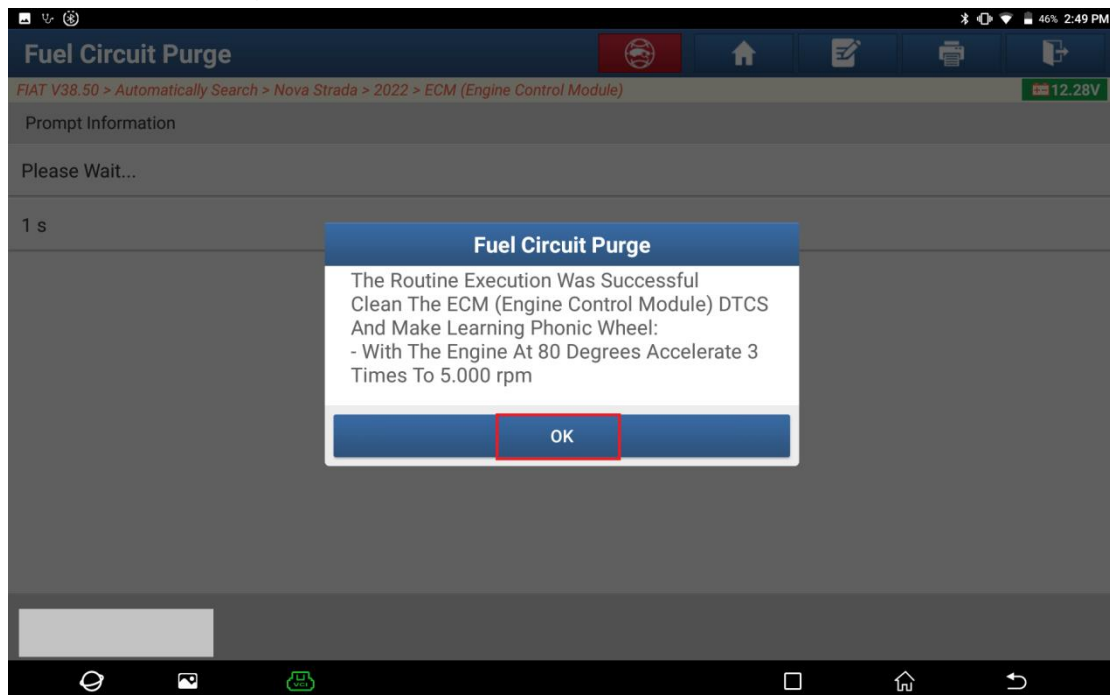

Statement:

The content of this document is copyrighted by LAUNCH TECH CO., LTD., and no individual or organization may quote or reprint it without consent.