

Jaguar XF 2016 Headlamp Level Sensor Calibration

Jaguar XF 2016, VIN: SAJBB4BG7GC*****

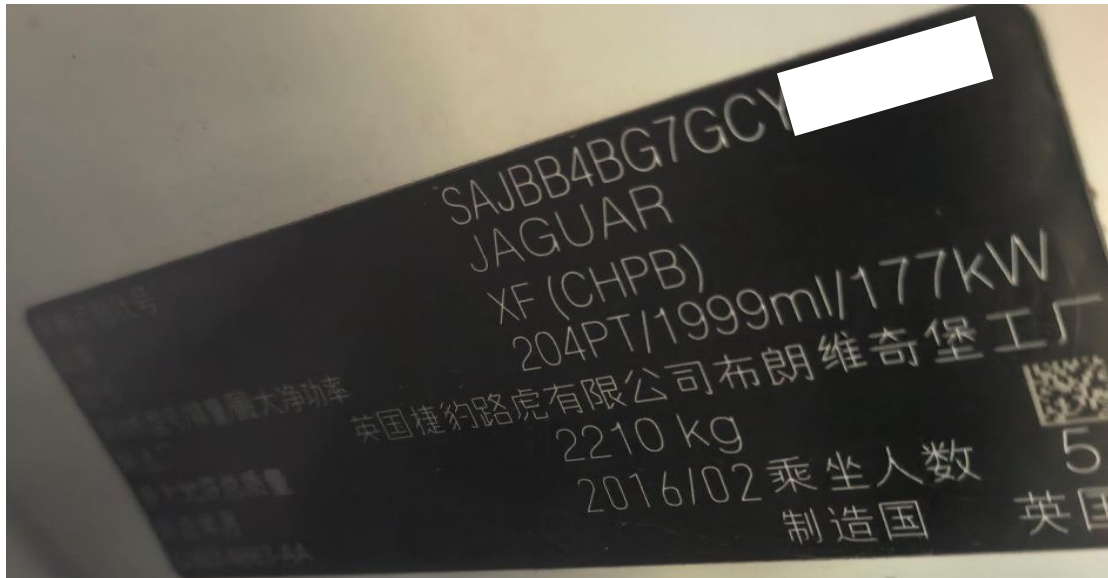

Function Description: This function is used to recalibrate the headlamp level sensor after replacing the headlamp or headlamp control module with a new one.

Supported Products: Launch PRO or PAD series comprehensive diagnostic equipment

Tested Product: X-431 PAD 5

1. On an X-431 PAD 5, choose [Jaguar] and choose [Intelligent Diagnose] to identify vehicle information. Confirm the details and click [Diagnostic]. (See the following figure.)

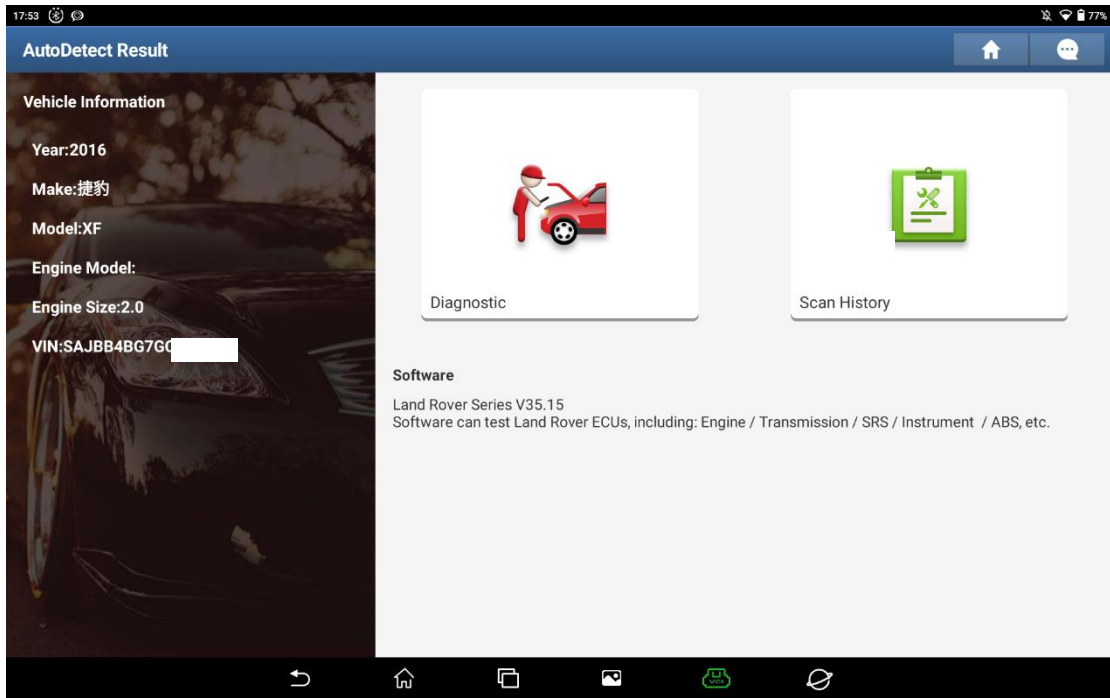

2. Click [Smart Detection] to scan the full vehicle systems. (See the following figure.)

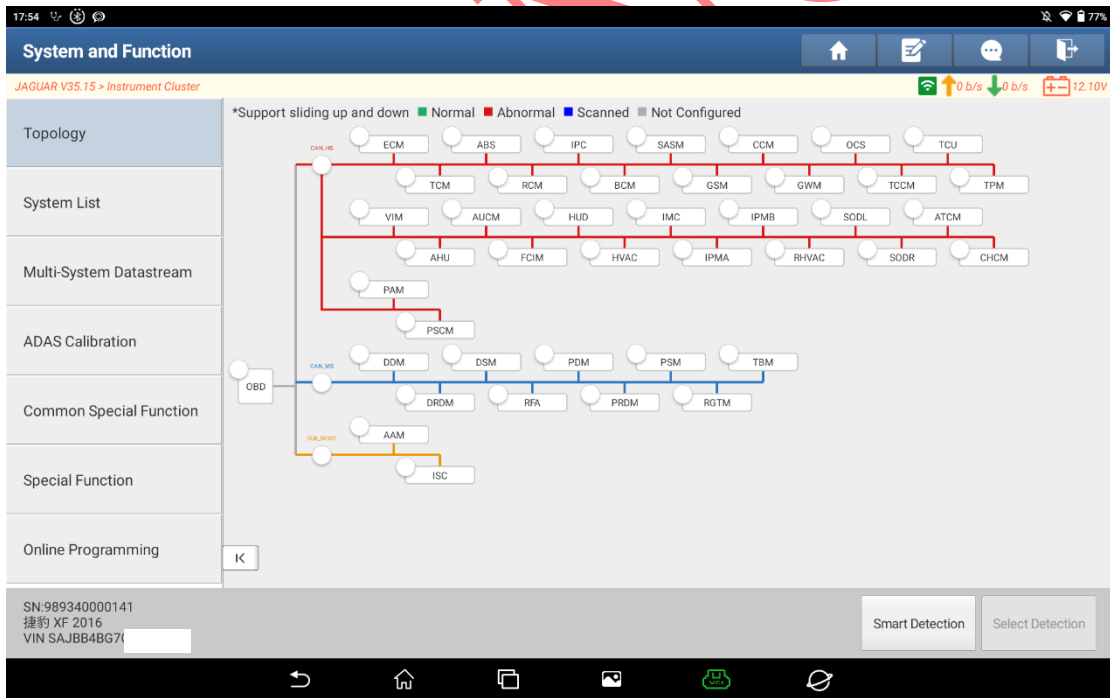

3. Choose [Common Special Function] on the left. (See the following figure.)

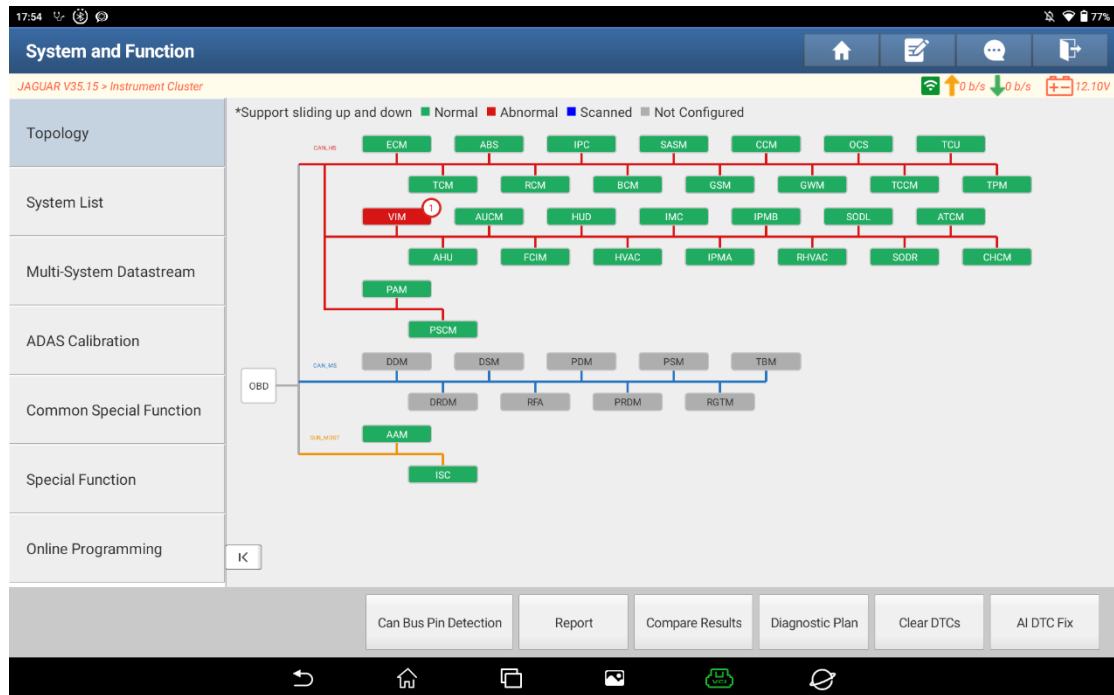

4. Choose [Adaptive Front Lighting]. (See the following figure.)

Special Function	
Oil Maintenance Reset	Brake Reset
Immobilizer Reset	Electric Throttle Relearn
TPMS Reset Database	DPF Regen
Steering Angle Reset	Air Level Calibration
Adaptive Front Lighting	Battery Matching
ABS Bleeding	Injector Coding
Windows Calibration	Seat Occupancy Calibration
Camera	EGR Adaption
AdBlue Reset	Coaxial Release

SN:989340000141
 捷豹 XF 2016
 VIN SAJBB4BG7G0

5. Choose [Lighting - Headlamp Leveling Height Sensor Calibration]. (See the following figure.)

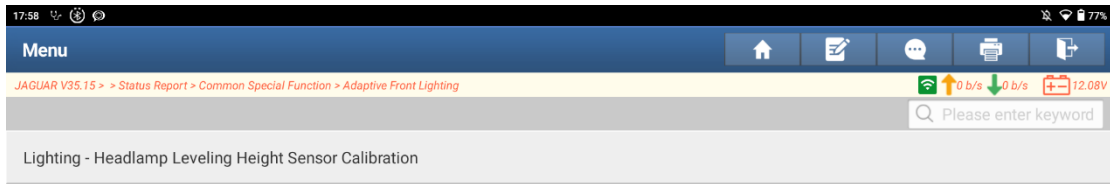

6. Click [OK]. (See the following figure.)

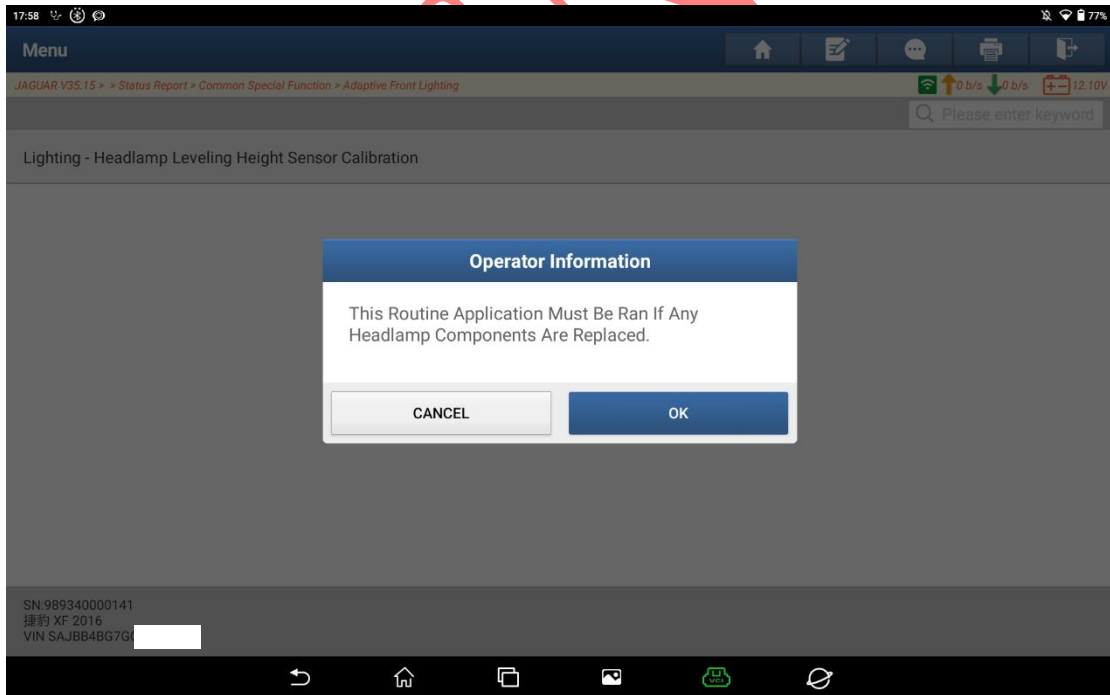

7. Turn on the ignition switch, and then click [OK]. (See the following figure.)

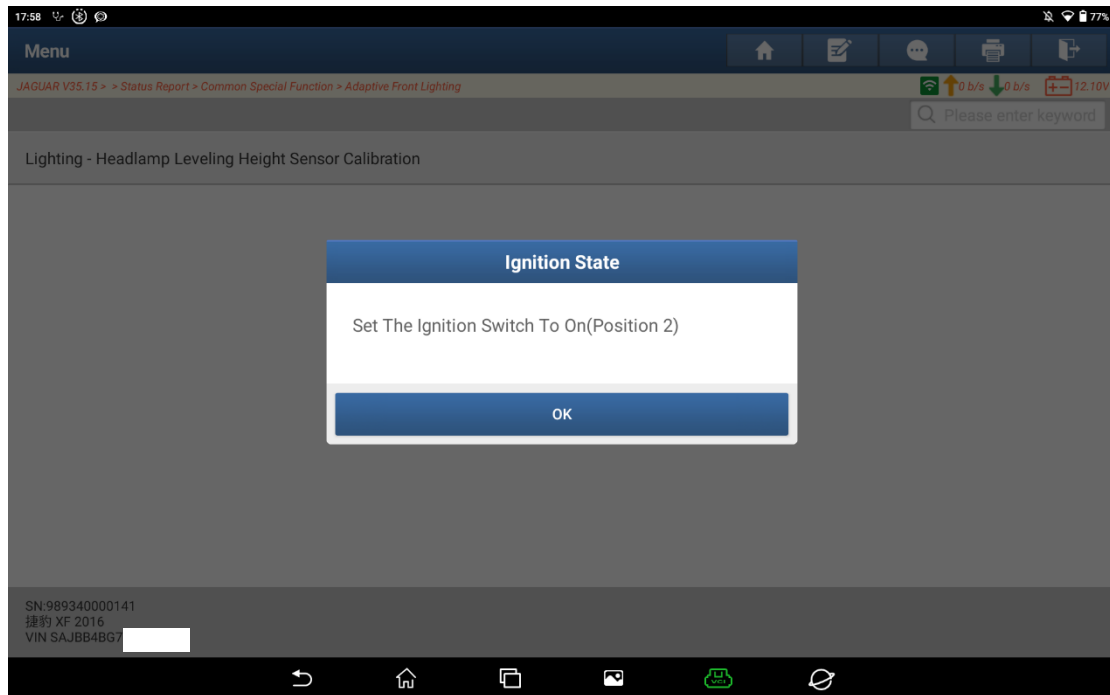

8. Confirm that the conditions are met, and then click [OK]. (See the following figure.)

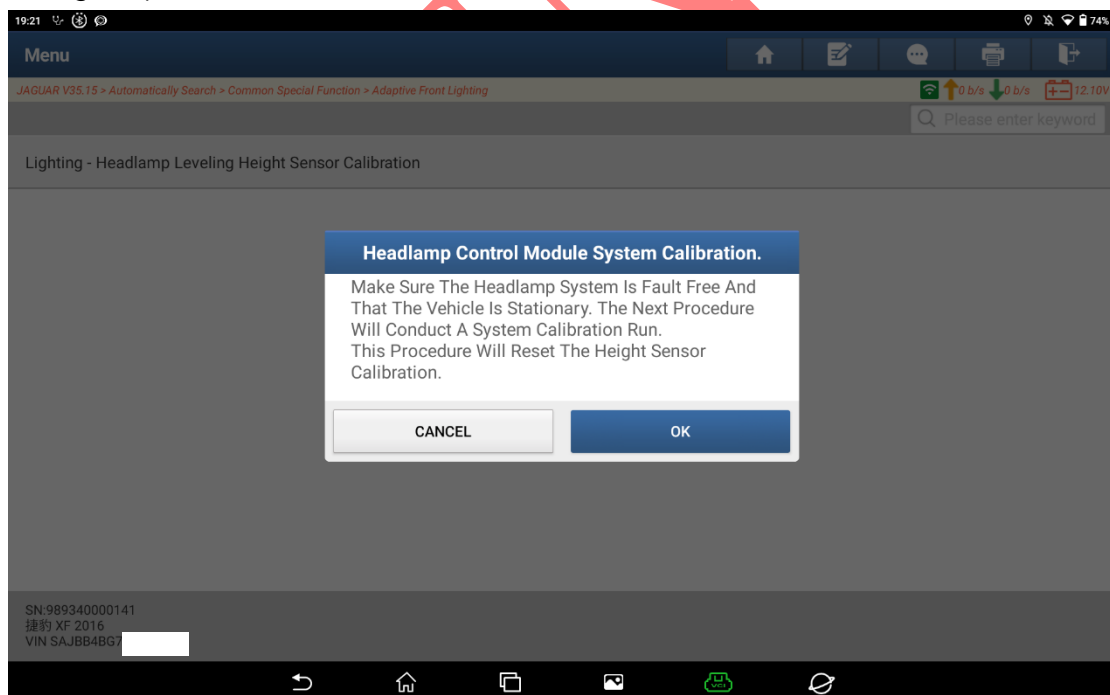

9. Headlamp leveling height sensor calibration in progress. (See the following figure.)

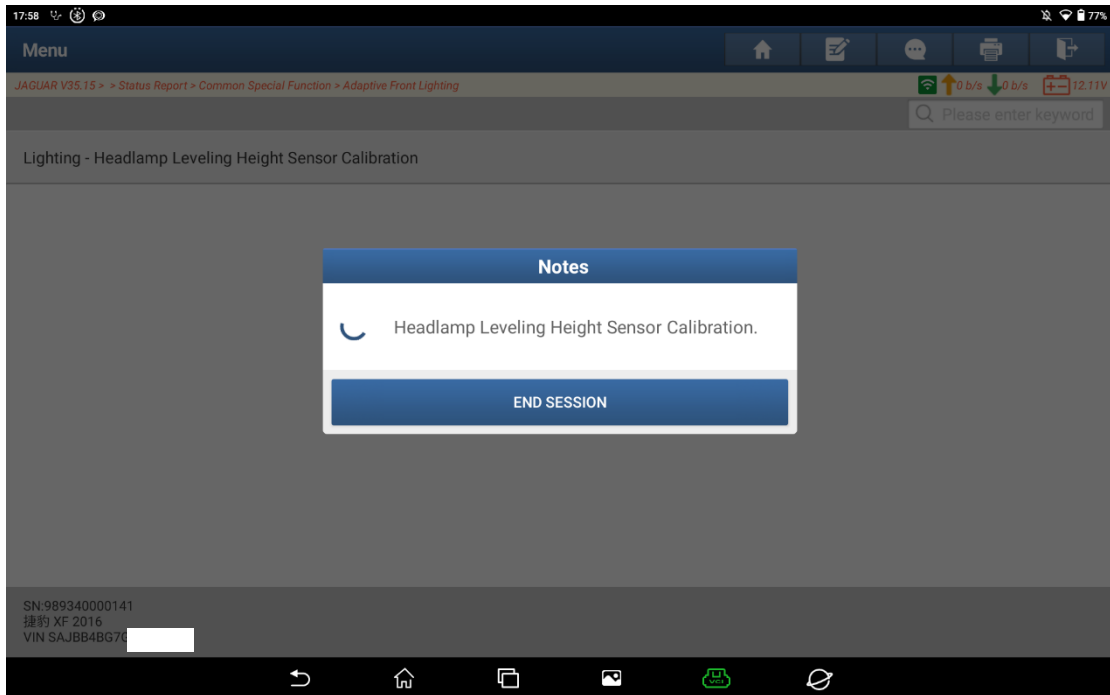

10. Routine completed. Click [OK]. (See the following figure.)

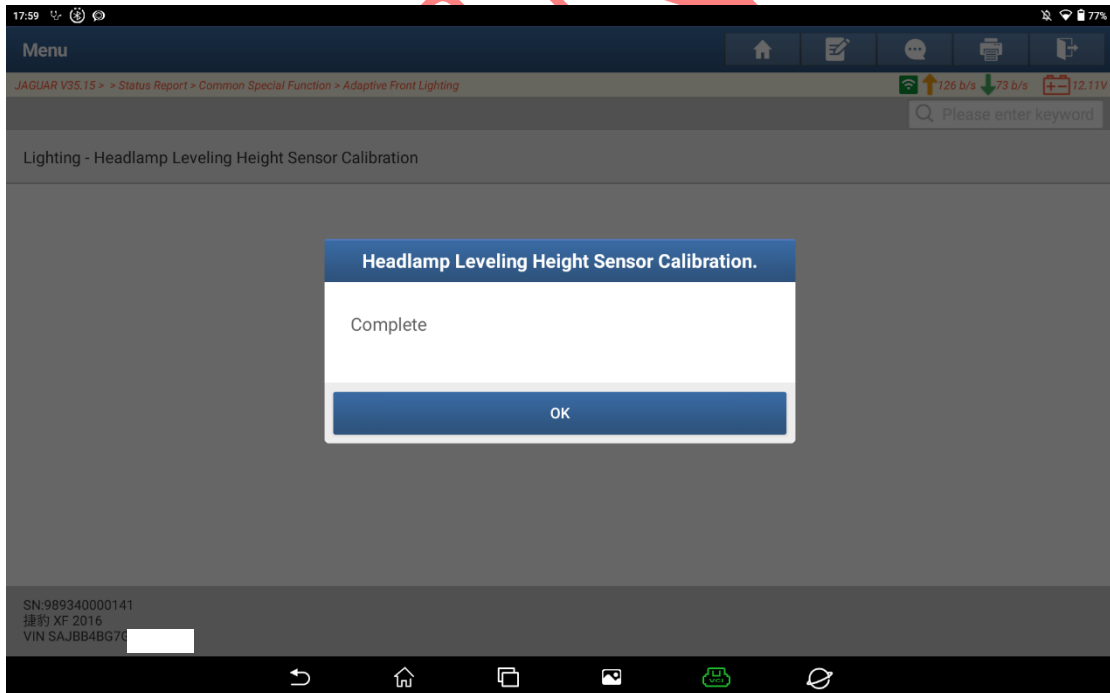

11. Module initialization in progress. Please wait. (See the following figure.)

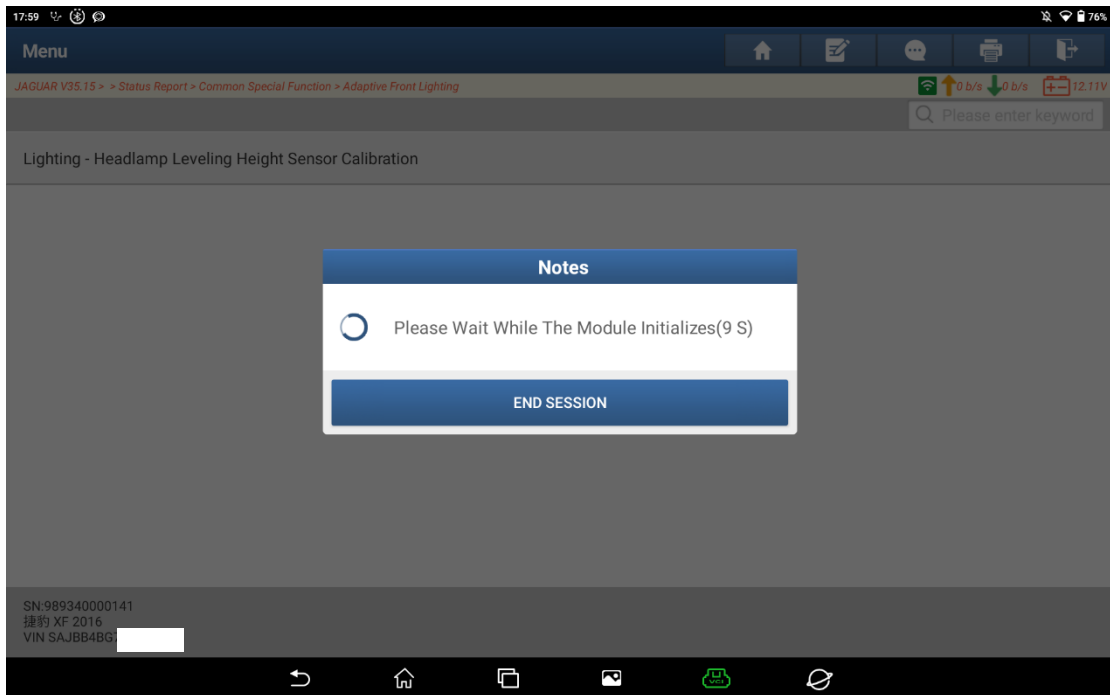

12. Turn off the ignition switch, and then click [OK]. (See the following figure.)

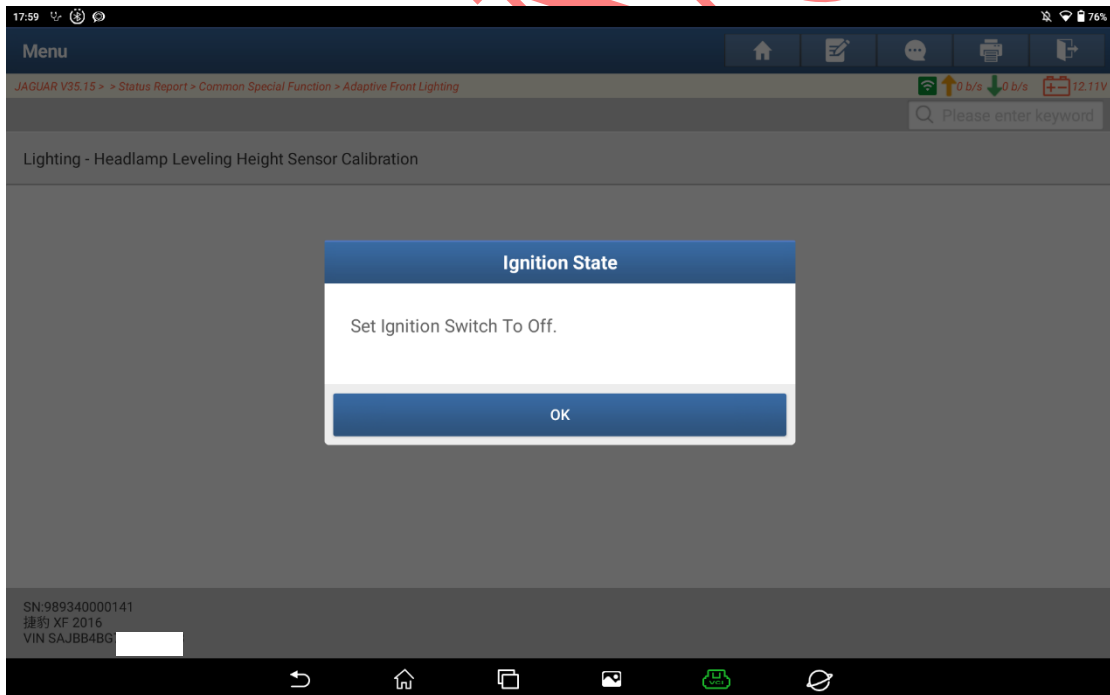

13. Turn on the ignition switch, and then click [OK]. (See the following figure.)

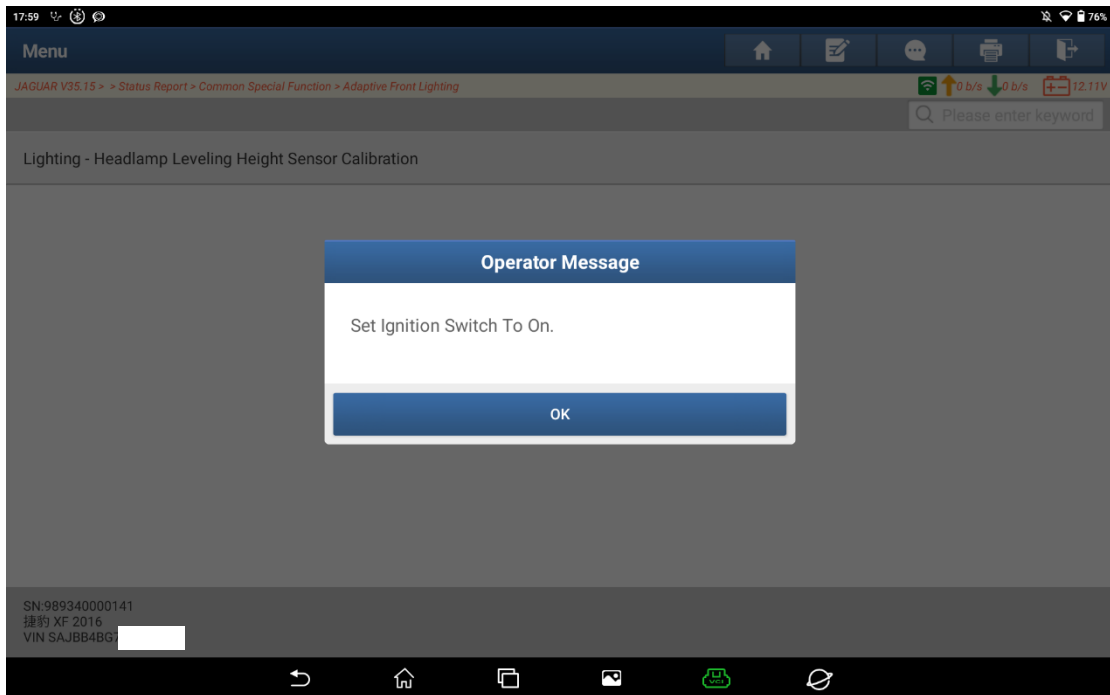

14. DTCs will be cleared. Click [OK]. (See the following figure.)

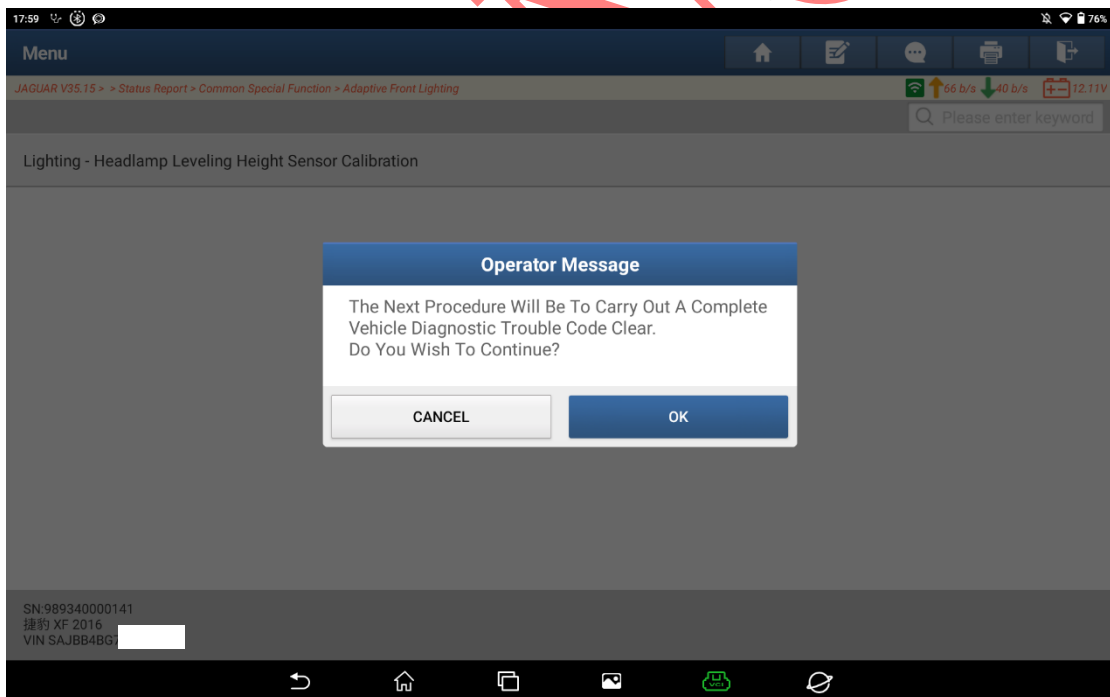

15. DTC clearing completed. Click [OK]. (See the following figure.)

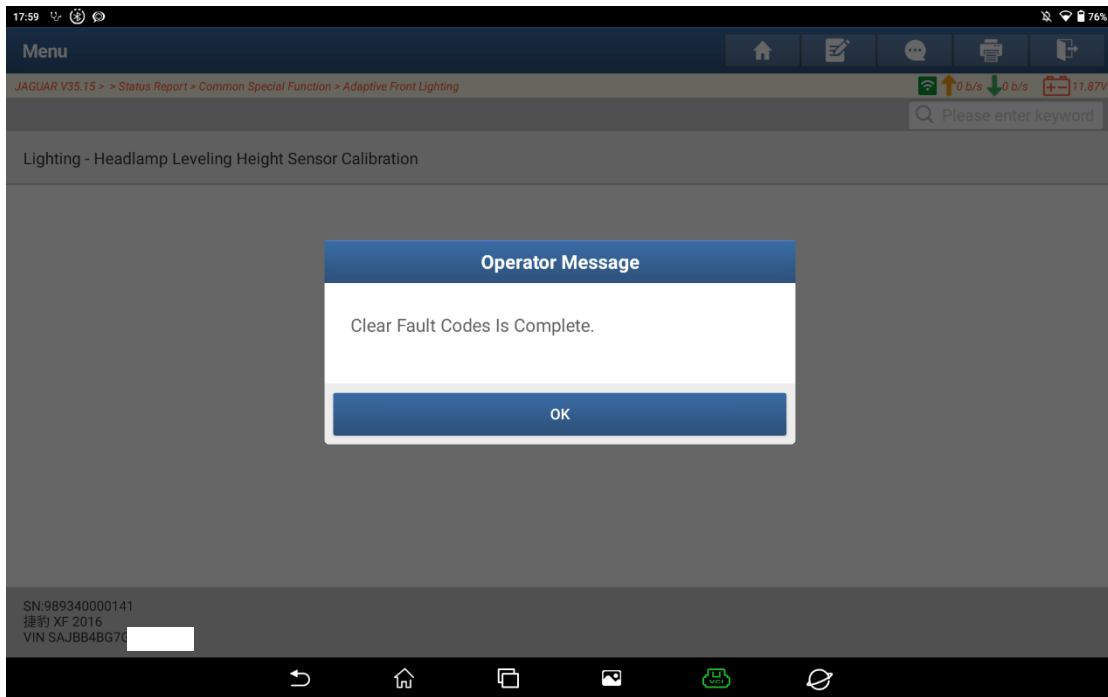

16. Turn off the ignition switch, and then click [OK]. (See the following figure.)

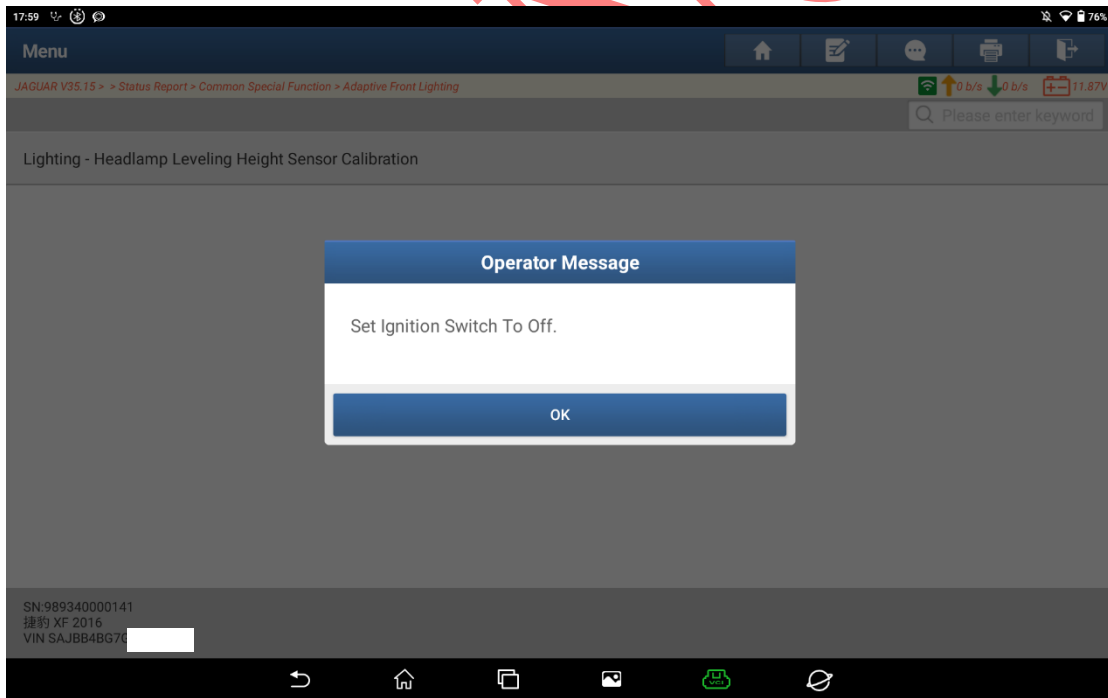

17. Turn on the ignition switch, and then click [OK]. (See the following figure.)

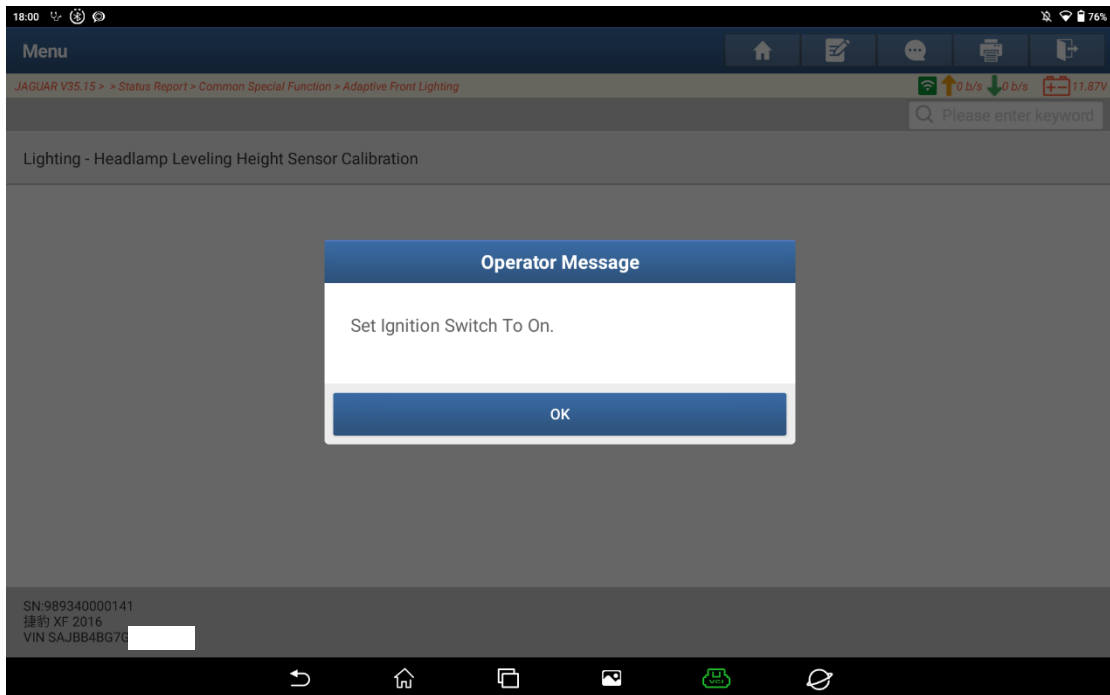

18. Control module procedure completed successfully. (See the following figure.)

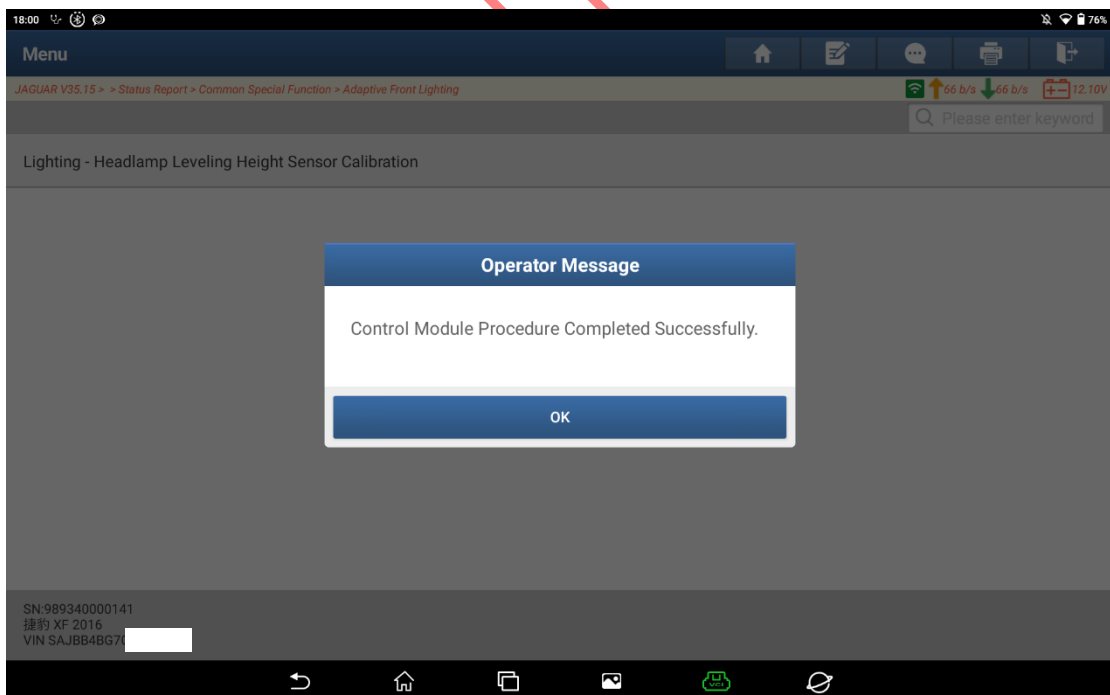

19. Turn off the ignition switch, and then click [OK]. Calibration completed. (See the following figure.)

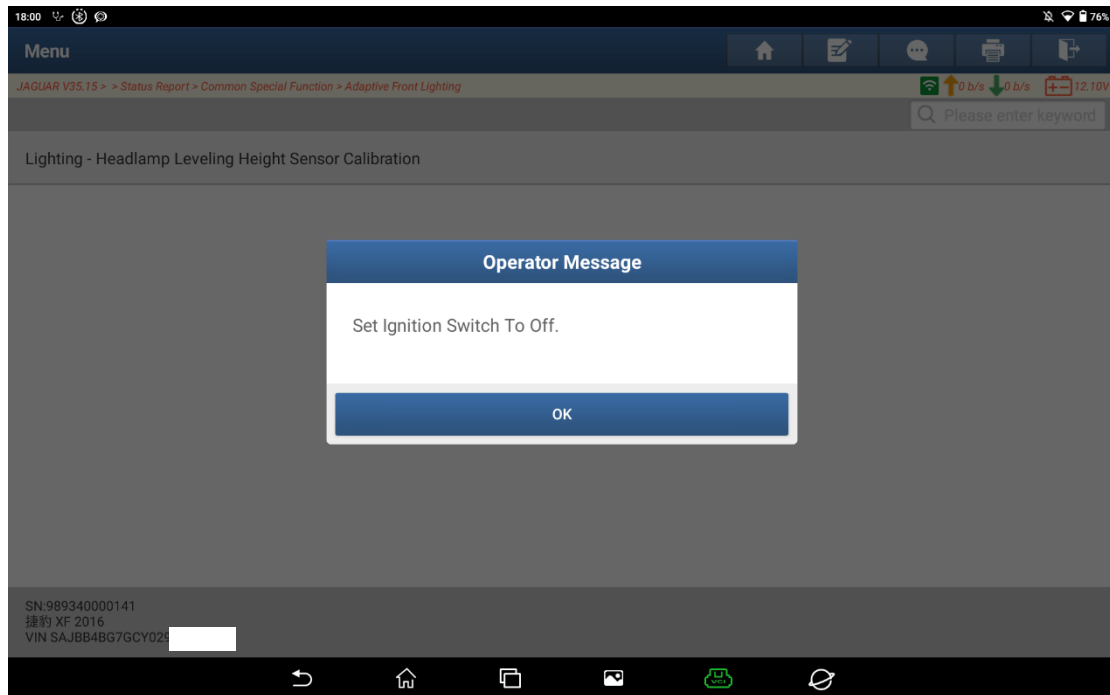

Statement:

The content of this document is copyrighted by LAUNCH TECH CO., LTD., and no individual or organization may quote or reprint it without consent.