

# LAUNCH

---

## Fiat ADAS Front Camera Calibration Instructions

### Test Model:

- 2015-2017 500X
- 2014-2017 DUCATO
- 2014-2017 RENEGADE
- 2016-2017 TORO

### Calibration Required:

- Front Camera/ECU Replaced.
- The Windscreen Replaced.
- Structural Changes/Adjustments on the Chassis.
- Level Sensor Replaced.
- The Fault code Exist.

### Pre-Calibration Preparation

1. Connect Pad III connector to vehicle, and enter Fiat software V35.95 or above.
2. Park The Vehicle With All Four Wheels On A Flat Surface Without Any Addition Load, The Steering Angle Is Set To Zero.
3. All Vehicle Doors Must Be Closed.
4. The Tire Pressure Is Set To Standard Value.
5. The Headlamps Must Be Turned Off.
6. The Ignition Must Be Switched On.
7. The Visual Field Of The Camera Is Free And Clean.
8. The Surrounding Area Is Sufficiently Bright, No Reflective Or Shiny Objects Around The Target.

### Calibration Setup

1. Use LAC01-09 Target.
2. The Distance (L) Between LAC Panel And The Front Of The Vehicle:1700mm/66.93inch.
3. ADAS (Advanced Driver Assistance Systems) Panel Is Placed Centered In Front Of The Vehicle.
4. ADAS (Advanced Driver Assistance Systems) Panel Is Placed Parallel In Front Of The Vehicle.
5. Adjust The Height (H) Of The LAC Panel To 1620mm( $\pm 10$ mm)/63.78inch( $\pm 0.4$ inch).
6. After First Part Of The Calibration Has Ended. Before Proceeding With Second Part, Please Set The Calibration Plate As Follows:
7. Use LAC01-09 Target.
8. The Distance (L) Between LAC Panel And Car Front Edge (License Plate):  
2700mm/106.30inch.
9. ADAS (Advanced Driver Assistance Systems) Panel Is Placed Centered In Front Of The Vehicle.

# LAUNCH

10. ADAS (Advanced Driver Assistance Systems) Panel Is Placed Parallel In Front Of The Vehicle.
11. Adjust The Height (H) Of The LAC Panel To 1620mm(+/-10mm)/63.78inch(+/-0.4inch).

## Calibration Notes

- All fault memory records related to calibration must have been processed;
- Once the procedure is started, it must be completed until its end.
- After the calibration is completed, it is best to make a road test to confirm that the fault indicator disappears.

## Steps:

1. Enter Fiat software and select "ADAS Calibration".

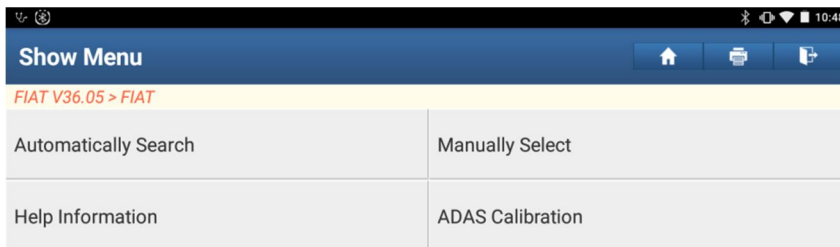

2. Select the right model.

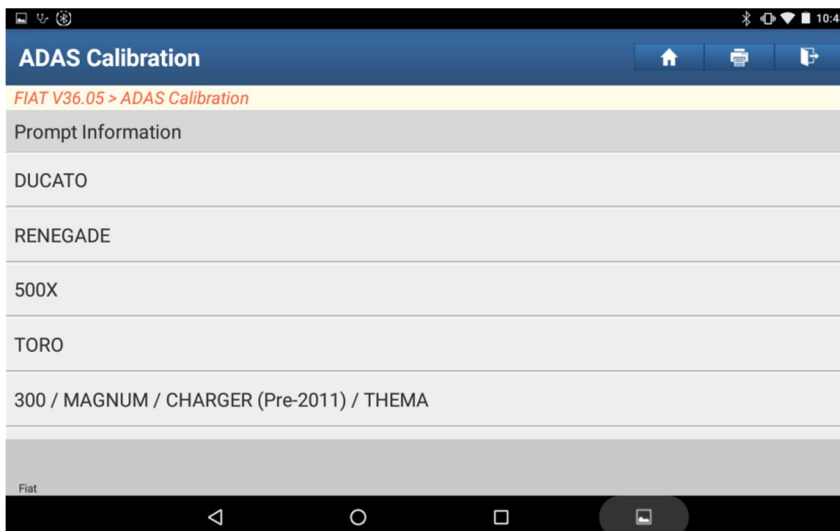

# LAUNCH

3. Select the corresponding ADAS special function and click “Continue”.

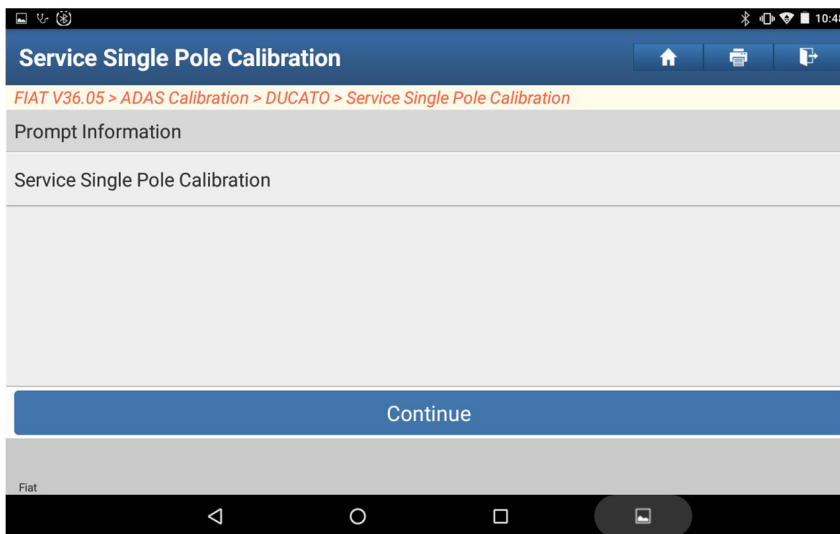

4. Read the pre-calibration preparation carefully and do as it say, then click “OK”.

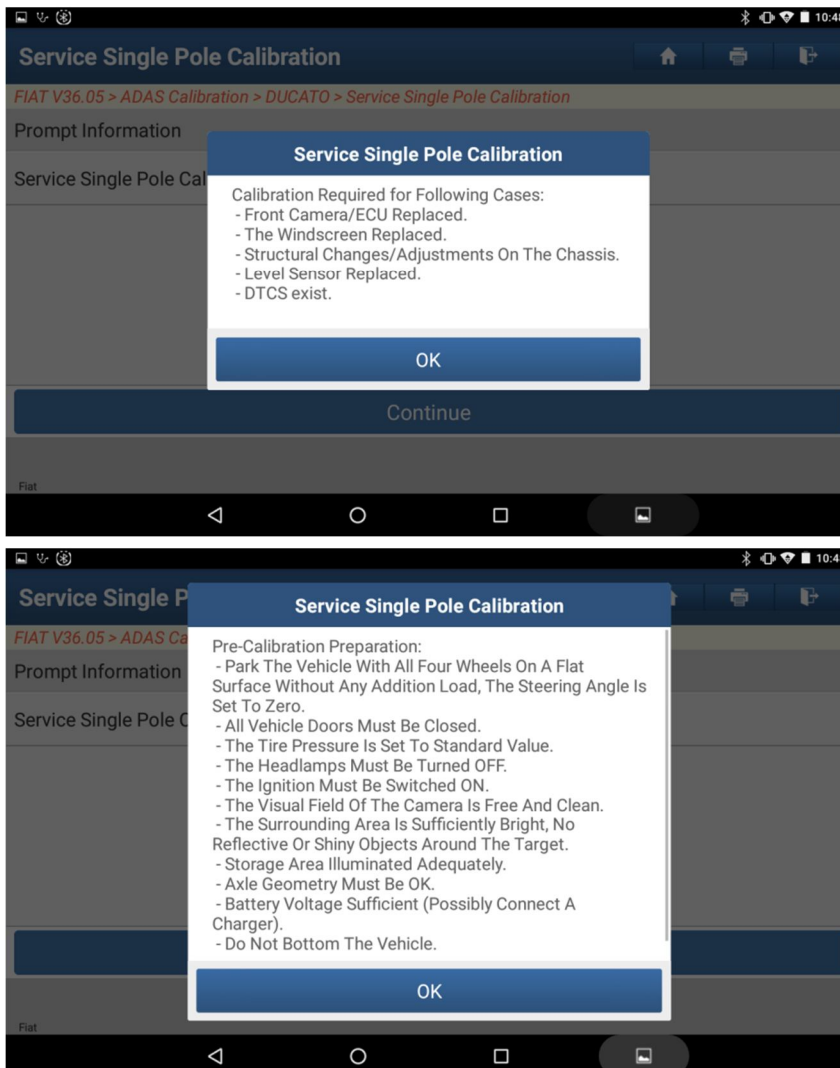

# LAUNCH

- Place the target according to the text prompt, click "Picture" to view the schematic diagram, or click "Continue" to complete the first step of calibration.

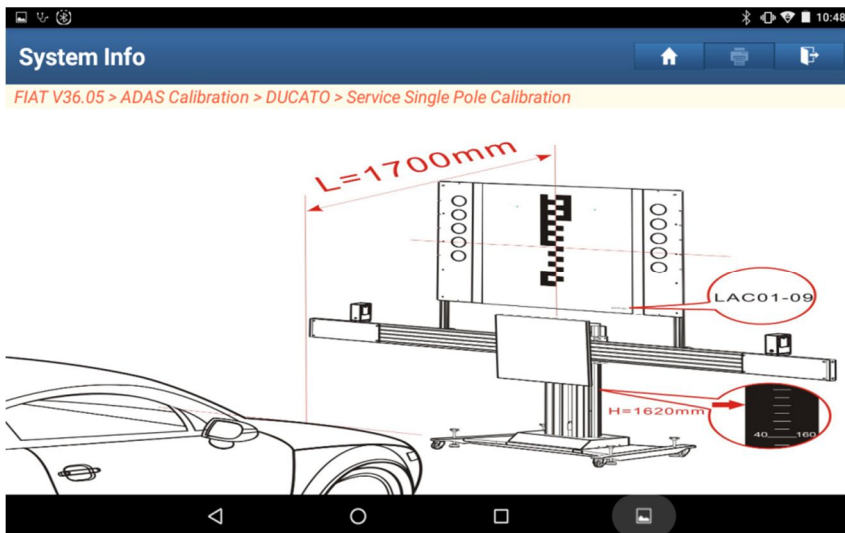
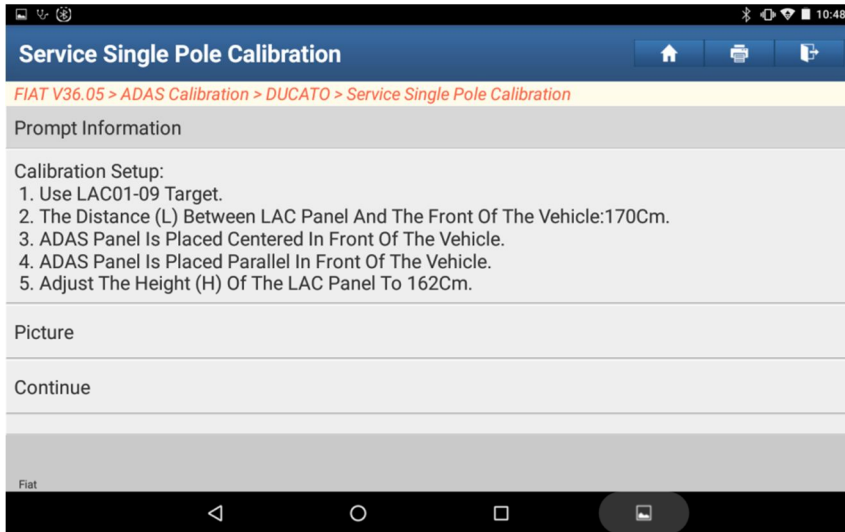

- Click "continue" to run the second part of the test.

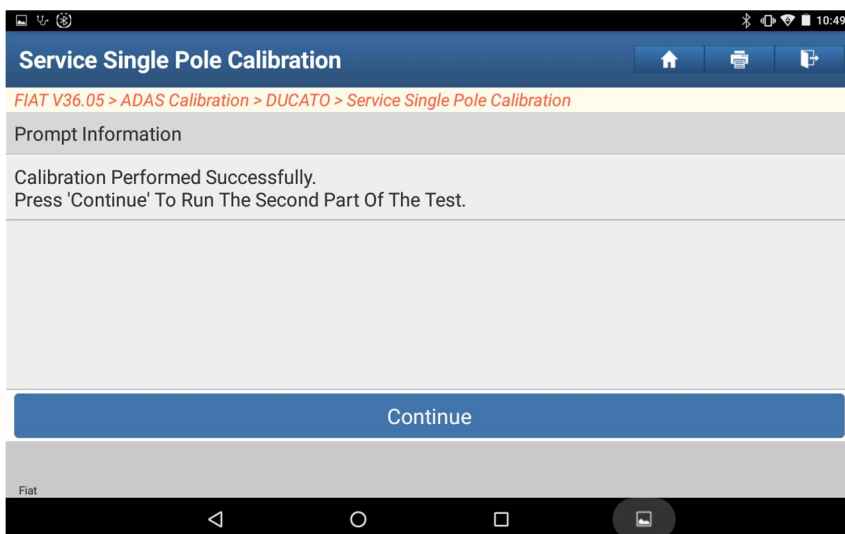

# LAUNCH

- Place the target according to the text prompt, click "Picture" to view the schematic diagram, or click "Continue" to complete the first step of calibration.

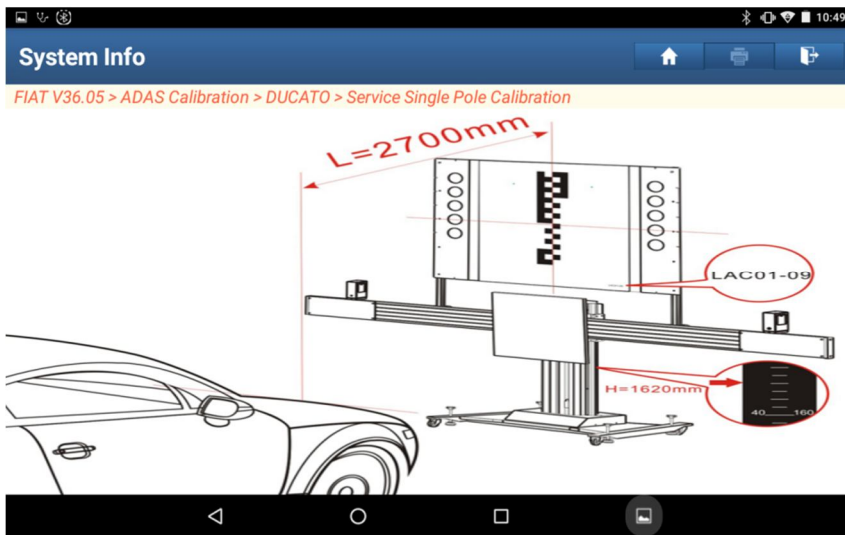
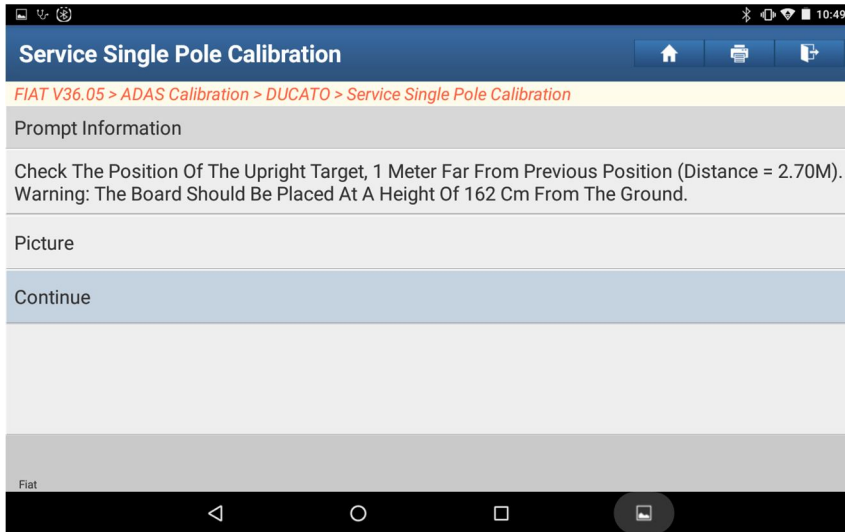

- After finish second part, calibration finished.

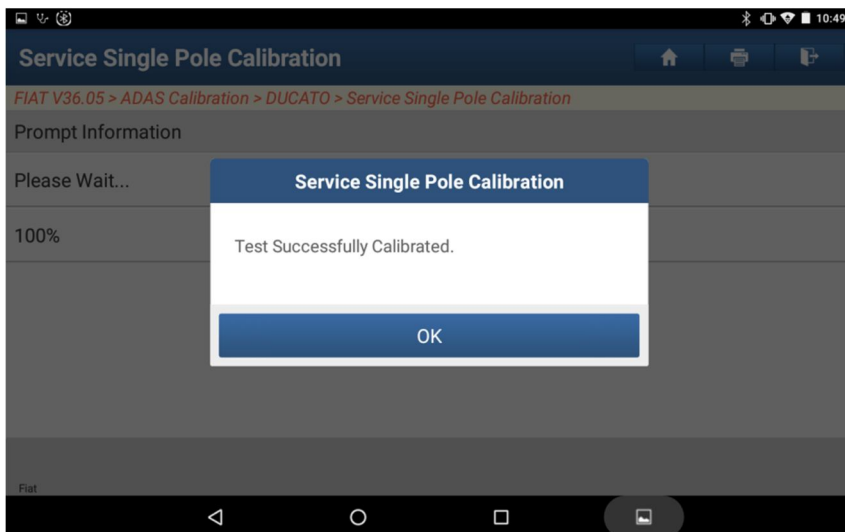

# LAUNCH

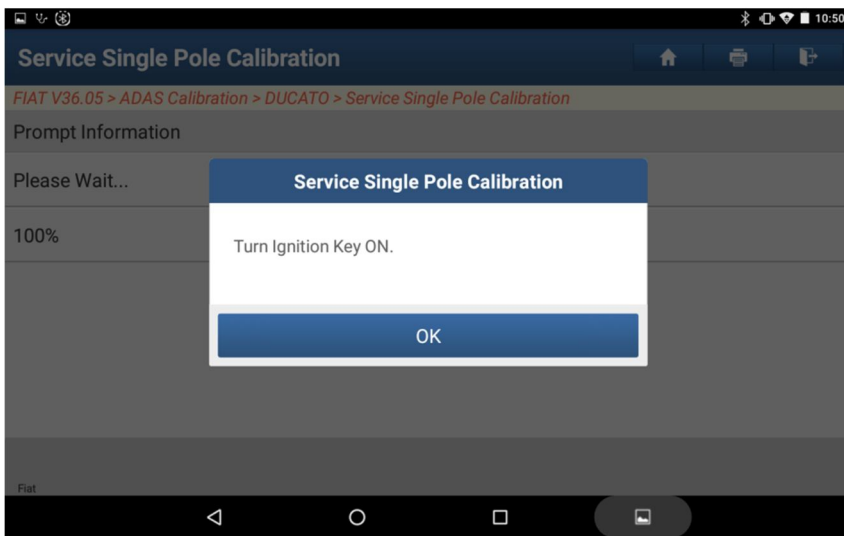
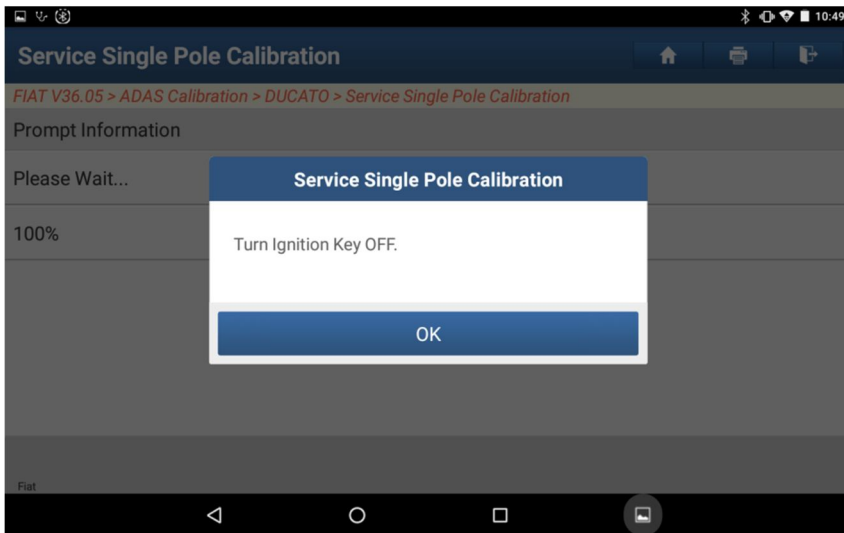

The end.